

K-DRV

Unidirectional flow control valves

HANSA FLEX

Свойства

Работно налягане	макс. 10 bar
работна температура	max. +70 °C
уплътняващ материал	NBR
корпус	Alu eloxed
вътрешни части	Brass

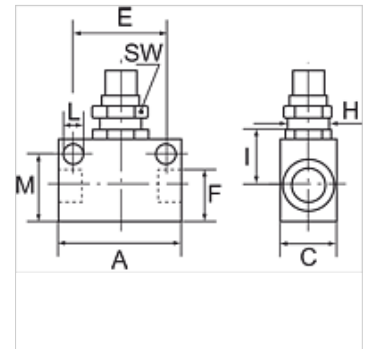

Указание

Други данни при запитване.

Описание

These valves are restricted in the flow direction and have free passage in the opposite direction.

Артикул

Обозначение	Резба	A (mm)	C (mm)	E (mm)	H размер	I (mm)	L (mm)	M (mm)	SW (mm)
K- 07 30 12 36	M 5	25,0	12,0	18,0	M 9 x 0.75 mm	10,0	3,2	12,2	11
K- 07 30 12 37	G 1/8	34,0	16,0	24,0	M 12 x 0.75 mm	15,0	4,5	16,4	15
K- 07 30 12 38	G 1/4	50,0	25,0	35,0	M 18 x 1.5 mm	24,0	6,5	23,8	22
K- 07 30 12 39	G 3/8	58,0	25,0	40,0	M 18 x 1.5 mm	24,0	6,5	25,3	22
K- 07 30 12 40	G 1/2	65,0	30,0	50,0	M 22 x 1.5 mm	29,0	6,5	33,0	26