

# K-DRS ELK GERAETESTECKER

Pressure switches, connection with plug connector, type A acc. to DIN 43650

**HANSA FLEX**

## Свойства

Диапазон на използване	Pneumatic applications
честота на включване	200/min.
напрежение при включване	max. 250 V AC / 28 V DC
вид защита	IP 65 (DIN 43650), IP 67 (M 12 x 1)
Температурен диапазон	-10 °C to +80 °C
настройваща се капачка	Aluminium, powder-coated
корпус	Special die-cast material
мембрана, уплътнение	NBR

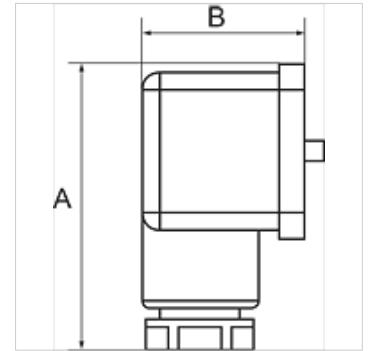

## Указание

Други данни при запитване.

## Описание

For converting pneumatic to electrical signals. Designed for use in rough vacuum applications (technical vacuum). Universal switch type, suitable as NC, NO or changeover contact. These devices are free from paint-wetting impairment substances (PWIS).

## Артикул

Обозначение	Съединение	диапазон за настройка	A (mm)	B (mm)
K- 07 30 28 45	G 1/4	0,2 - 2,0 bar	48,0	28,0
K- 07 30 28 46	G 1/4	0,5 - 8,0 bar	48,0	28,0
K- 07 30 28 47	G 1/4	1,0 - 16,0 bar	48,0	28,0