

# K-BKR IG IG

Brass ball valves, female/female thread

**HANSA FLEX**

## Свойства

|                       |   |
|-----------------------|---|
| работно налягане      | Max. 25 bar                                 |
| Работно налягане      | Max. 28 bar                                 |
| работна температура   | -20 oC to +100 oC                           |
| резба описание        | G thread acc. DIN EN ISO 228-1              |
| корпус                | Nickel-plated brass                         |
| лост                  | Steel Q235-A (1.0038) with blue PVC coating |
| сачма                 | Nickel-plated brass                         |
| сферично уплътнение   | PTFE  |
| уплътнение на шпиндел | NBR   |

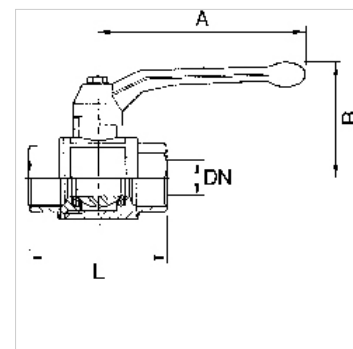

## Указание

Други данни при запитване.

## Артикул

| Обозначение    | DN | Резба | A<br>(mm) | B<br>(mm) | L<br>(mm) |
|----------------|----|-------|-----------|-----------|-----------|
| K- 07 30 21 61 | 8  | 1/4   | 75,0      | 38,0      | 40,0      |
| K- 07 30 21 62 | 10 | 3/8   | 75,0      | 38,0      | 40,0      |
| K- 07 30 21 63 | 15 | 1/2   | 96,0      | 45,0      | 50,0      |
| K- 07 30 21 64 | 19 | 3/4   | 98,0      | 45,0      | 55,0      |
| K- 07 30 21 65 | 25 | 1     | 118,0     | 55,0      | 63,0      |
| K- 07 30 21 66 | 31 | 1 1/4 | 118,0     | 58,0      | 73,0      |
| K- 07 30 21 67 | 37 | 1 1/2 | 138,0     | 73,0      | 83,0      |
| K- 07 30 21 68 | 45 | 2     | 160,0     | 82,0      | 99,0      |