

K-VERSCHLUSSKAPPEN RUND

Hexagonal caps, round

HANSA FLEX

Свойства

| | |
|------------------|------------------------------|
| работно налягане | Max. 20 bar |
| резба вътрешно | Parallel to DIN EN ISO 228-1 |
| Материал | Stainless steel 1.4408 |

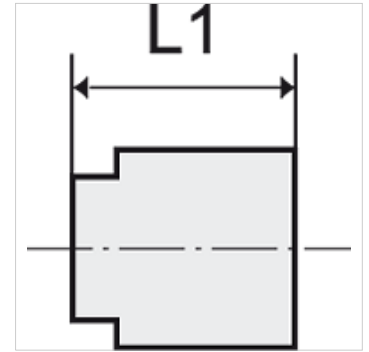

Указание

The dimensions of the standard screw fittings may change slightly during the life of the catalogue as a result of optimisation processes.

Други данни при запитване.

Артикул

| Обозначение | Резба | L1 (mm) | Ø (mm) |
|----------------|---------|------------|-----------|
| K- 07 40 39 31 | G 1/8 | 14,0 | 14,6 |
| K- 07 40 39 32 | G 1/4 | 15,4 | 17,0 |
| K- 07 40 39 33 | G 3/8 | 15,9 | 21,0 |
| K- 07 40 39 34 | G 1/2 | 20,0 | 28,0 |
| K- 07 40 39 35 | G 3/4 | 23,6 | 34,0 |
| K- 07 40 39 36 | G 1 | 28,0 | 40,0 |
| K- 07 40 39 37 | G 1 1/4 | 30,0 | 49,0 |
| K- 07 40 39 38 | G 1 1/2 | 31,2 | 55,0 |
| K- 07 40 39 39 | G 2 | 35,4 | 69,0 |