

K-XV VALUE LINE MS NI

Double nipples

HANSA FLEX

Свойства

макс. работно налягане 60 bar

макс. работна температура 150 °C

Материал месинг никелиран

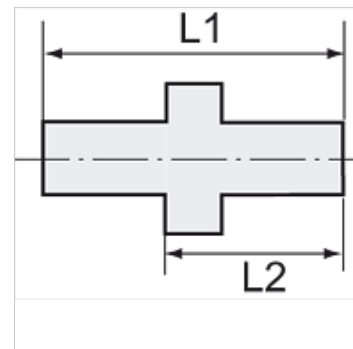
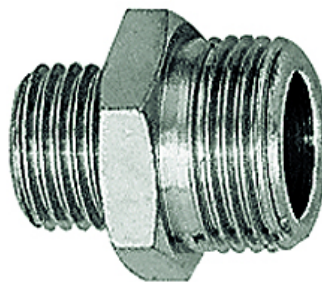

Указание

The dimensions of the standard screw fittings may change slightly during the life of the catalogue as a result of optimisation processes.

Други данни при запитване.

Описание

For air, water, steam, oil, etc.

Артикул

Обозначение	резба 1	резба 2	L1 (mm)	L2 (mm)	SW
K- 07 40 12 95	M 5	M 5	11,5	7,5	8 mm
K- 07 40 12 96	G 1/8	G 1/8	16,5	10,5	14 mm
K- 07 40 12 97	G 1/8	G 1/4	19,0	13,0	17 mm
K- 07 40 12 98	G 1/4	G 1/4	21,0	13,0	17 mm
K- 07 40 12 99	G 1/4	G 3/8	22,0	14,0	19 mm
K- 07 40 13 00	G 1/4	G 1/2	23,5	15,5	24 mm
K- 07 40 13 01	G 3/8	G 3/8	23,0	14,0	19 mm
K- 07 40 13 02	G 3/8	G 1/2	24,5	15,5	24 mm
K- 07 40 13 03	G 1/2	G 1/2	25,5	15,5	24 mm