

# K-SCHALTVENTILE 3/2 MULTIFIX MINI

On-off valves (3/2-way valves)

**HANSA FLEX**

## Свойства

входящо налягане	Min. 2 bar, max. 10 bar
температура на средата	max. 60 °C
околна температура	Max. 60 °C
електрическо съединение	Device plug PG 9, type B, EN 175301-803
вид защита	IP 65 (P 54) acc. to DIN 40050
протичане	1600 l/min
продължителност на включване относителна	100 %
съединение за обезвъздушаване	Silencer G 1/4
уплътняващ материал	NBR
корпус	Die-cast zinc
измерване на стойността на протичане	At P1 = 6 bar and pressure drop $\Delta p$ = 1 bar

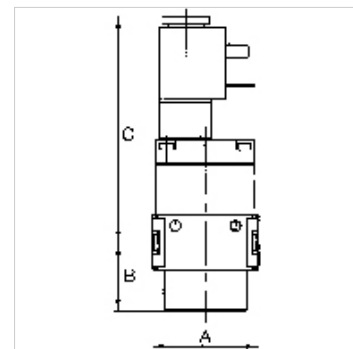

## Указание

If several devices in the »multifix-mini« Series are assembled together, the maximum working pressure is 12 bar.

Други данни при запитване.

## Описание

Pneumatic systems or parts of systems can be switched on and off by means of an electrical signal. When they are switched off, the system is relieved at the same time.

## Артикул

Обозначение	Резба	магнитна бобина	A (mm)	B	C (mm)	Конструктивен размер
K- 07 25 11 62	G 1/4	230 V AC, 50 Hz	45,0	29,0 mm	96,0	0
K- 07 25 11 63	G 1/4	110 V AC, 50 Hz	45,0	29,0 mm	96,0	0
K- 07 25 11 64	G 1/4	24 V DC	45,0	29,0 mm	96,0	0

## Резервни части

K-KOPPELPAKET MEHR	Coupling packet
K-GERAETESTECKER	Coupling socket
K-AUTOMAT ABLASSVENTIL	Automatic drain valve
K-MAGNETSPULE MULTIFIX	Solenoid
K-SCHALLDAE SINTERBR SCHLITZ	Silencers, sintered bronze, slotted