

K-RD DURCHGANGSFORM LEI VA

Check valve - straight-way type, lightweight series, stainless steel

HANSA FLEX

Свойства

Работно налягане	2 - 16 bar
работна температура	-20 °C to +150 °C
налягане на отваряне	min. 0.03 bar
уплътняващ материал	FKM
пружина	Stainless steel 1.4301
корпус	Stainless steel 1.4301

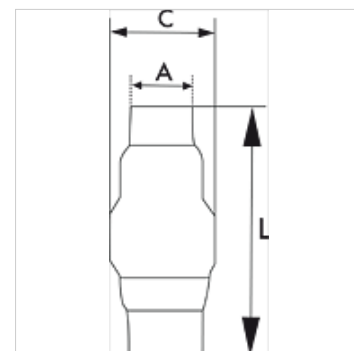

Указание

Други данни при запитване.

Описание

Stainless steel check valve with full bore and very low opening pressure, no maintenance required. Applications: Compressed air, water, neutral gases, gaseous and liquid non-corrosive media, oils.

Артикул

Обозначение	Резба	A (mm)	C (mm)	L (mm)
K- 07 30 29 23	G 1/4	20,0	32,0	55,9
K- 07 30 29 28	G 3/8	20,0	32,0	56,0
K- 07 30 29 22	G 1/2	25,0	32,0	55,6
K- 07 30 29 27	G 3/4	29,0	44,0	66,7
K- 07 30 29 19	G 1	36,0	53,0	83,6
K- 07 30 29 21	G 1 1/4	45,0	62,0	96,0
K- 07 30 29 20	G 1 1/2	51,0	78,0	114,0
K- 07 30 29 24	G 2	64,0	89,0	120,5
K- 07 30 29 25	G 2 1/2	80,0	113,0	141,5
K- 07 30 29 26	G 3	94,0	132,0	160,0