

K-SCHOTT-STECKVERB ABSP

Female bulkhead stop unions (pressure max. 10 bar)

HANSA FLEX

Свойства

работно налягане	Max. 10 bar, vacuum
Диапазон на използване	Air, vacuum
препоръчителни маркучи	PU or PA (nylon)
Течности	въздух под налягане
Стандарт	M thread acc. to DIN 13-1, with O-Ring
Температурен диапазон	0 °C to +60 °C
Материал	Plastic, Nickel plated brass
притискащ пръстен	Plastic

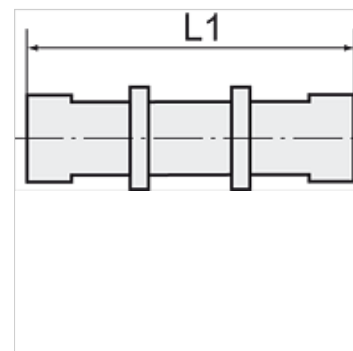
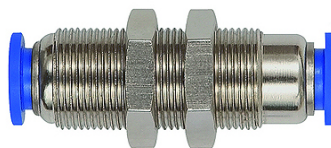

Указание

Други данни при запитване.

Описание

The air supply is completely shut off as soon as the hose is disconnected from the union.
The flow rate is only guaranteed if the hose is securely inserted.

Артикул

Обозначение	Резба	за външен Ø на маркуча	L1 (mm)	SW
K- 07 40 43 74	M 12 x 1.5	4 mm	41,0	14 mm
K- 07 40 43 75	M 14 x 1,5	6 mm	44,5	17 mm
K- 07 40 43 76	M 16 x 1,5	8 mm	50,3	19 mm
K- 07 40 43 77	M 20 x 1,5	10 mm	58,5	24 mm
K- 07 40 43 78	M 24 x 1,5	12 mm	62,2	27 mm