

K-L-MEHRFACHVERT 3 DR AGR OR

Multiple union elbows with inner hex, 3 outlets, swivel type, parallel male thread with O-ring

HANSA FLEX

Свойства

| | |
|------------------------|--|
| работно налягане | Max. 15 bar, coarse vacuum |
| Диапазон на използване | Air, vacuum |
| препоръчителни маркучи | PU or PA (nylon) |
| Течности | Compressed air and all gases or liquids that are compatible with the materials |
| Температурен диапазон | -20 °C to +80 °C |
| уплътняваща повърхност | Parallel version: O-ring in housing |
| Материал | Plastic, Nickel plated brass |
| притискащ пръстен | Plastic |

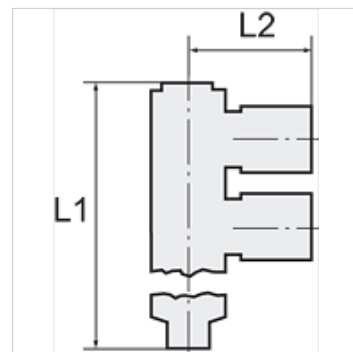

Указание

Други данни при запитване.

Описание

Push-in fittings series manufactured in plastic and nickel-plated brass. All parts are suitable for use with hoses, tubes or pipes made of plastic and copper.

Артикул

| Обозначение | Резба | за външен Ø на маркуча | вътрешен шестостен (mm) | L1 (mm) | L2 (mm) | SW |
|----------------|-------|------------------------|-------------------------|---------|---------|-------|
| K- 07 40 06 11 | G 1/8 | 4 mm | 4,0 | 59,1 | 22,5 | 14 mm |
| K- 07 40 06 12 | G 1/8 | 6 mm | 4,0 | 59,1 | 21,5 | 14 mm |
| K- 07 40 06 13 | G 1/8 | 8 mm | 4,0 | 59,1 | 24,5 | 14 mm |
| K- 07 40 06 09 | G 1/4 | 6 mm | 6,0 | 79,5 | 23,5 | 17 mm |
| K- 07 40 06 10 | G 1/4 | 8 mm | 6,0 | 79,5 | 26,5 | 17 mm |
| K- 07 40 06 07 | G 1/4 | 10 mm | 6,0 | 79,5 | 29,9 | 17 mm |
| K- 07 40 06 08 | G 1/4 | 12 mm | 6,0 | 79,5 | 30,8 | 17 mm |
| K- 07 40 06 16 | G 3/8 | 8 mm | 8,0 | 82,2 | 28,5 | 20 mm |
| K- 07 40 06 14 | G 3/8 | 10 mm | 8,0 | 82,2 | 31,9 | 20 mm |
| K- 07 40 06 15 | G 3/8 | 12 mm | 8,0 | 82,2 | 32,8 | 20 mm |