

# K-Y-STECK VERSCH DREH AG-K

Male branch Y-fittings, swivel type, conical male thread, coated

**HANSA FLEX**

## Свойства

|                        |  |
|------------------------|--|
| работно налягане       | Max. 15 bar, coarse vacuum   |
| диапазон на използване | Air, vacuum  |
| препоръчителни маркучи | PU or PA (nylon)   |
| Течности               | Compressed air and all gases or liquids that are compatible with the materials |
| Температурен диапазон  | -20 °C to +80 °C   |
| уплътняваща повърхност | Conical version: thread coating  |
| Материал               | Plastic, Nickel plated brass   |
| притискащ пръстен      | Plastic  |

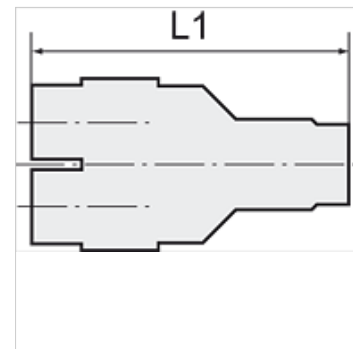
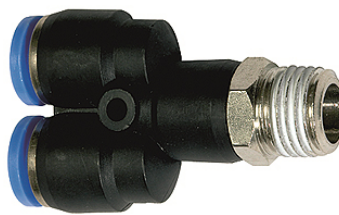

## Указание

Други данни при запитване.

## Описание

Push-in fittings series manufactured in plastic and nickel-plated brass. All parts are suitable for use with hoses, tubes or pipes made of plastic and copper.

## Артикул

| Обозначение    | Резба | за външен Ø на маркуча | L1<br>(mm) | SW    |
|----------------|-------|------------------------|------------|-------|
| K- 07 40 03 31 | R 1/8 | 4 mm                   | 42,0       | 10 mm |
| K- 07 40 03 32 | R 1/8 | 6 mm                   | 43,5       | 12 mm |
| K- 07 40 03 33 | R 1/8 | 8 mm                   | 46,8       | 14 mm |
| K- 07 40 03 29 | R 1/8 | 10 mm                  | 56,0       | 17 mm |
| K- 07 40 03 30 | R 1/8 | 12 mm                  | 59,8       | 21 mm |
| K- 07 40 03 26 | R 1/4 | 4 mm                   | 45,0       | 14 mm |
| K- 07 40 03 27 | R 1/4 | 6 mm                   | 46,0       | 14 mm |
| K- 07 40 03 28 | R 1/4 | 8 mm                   | 48,8       | 14 mm |
| K- 07 40 03 24 | R 1/4 | 10 mm                  | 58,0       | 17 mm |
| K- 07 40 03 25 | R 1/4 | 12 mm                  | 61,8       | 21 mm |
| K- 07 40 03 37 | R 3/8 | 6 mm                   | 47,5       | 17 mm |
| K- 07 40 03 38 | R 3/8 | 8 mm                   | 50,3       | 17 mm |
| K- 07 40 03 34 | R 3/8 | 10 mm                  | 59,0       | 17 mm |
| K- 07 40 03 35 | R 3/8 | 12 mm                  | 62,8       | 21 mm |
| K- 07 40 03 36 | R 3/8 | 16 mm                  | 72,0       | 24 mm |
| K- 07 40 03 22 | R 1/2 | 6 mm                   | 51,0       | 21 mm |
| K- 07 40 03 23 | R 1/2 | 8 mm                   | 53,8       | 21 mm |
| K- 07 40 03 19 | R 1/2 | 10 mm                  | 62,5       | 21 mm |
| K- 07 40 03 20 | R 1/2 | 12 mm                  | 65,8       | 21 mm |
| K- 07 40 03 21 | R 1/2 | 16 mm                  | 75,0       | 24 mm |