

# K-DRV AG-K STECK SCHL GEW

Unidirectional flow control valves with parallel male thread and plug connection, straight type, air restriction from tube to port

**HANSA FLEX**

## Свойства

работно налягане	Max. 15 bar, coarse vacuum
Диапазон на използване	Air, vacuum
препоръчителни маркучи	PU or PA (nylon)
Течности	Compressed air and all gases or liquids that are compatible with the materials
Температурен диапазон	-20 °C to +80 °C
уплътняваща повърхност	Parallel version: O-ring in housing, Conical version: thread coating
Материал	Plastic, Nickel plated brass
притискащ пръстен	Plastic

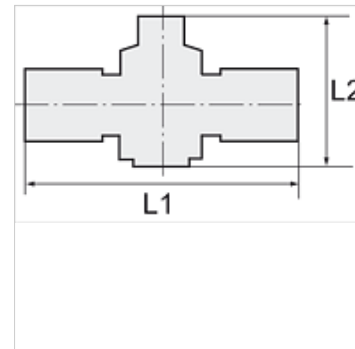

## Указание

Други данни при запитване.

## Описание

Push-in fittings series manufactured in plastic and nickel-plated brass. All parts are suitable for use with hoses, tubes or pipes made of plastic and copper.

## Артикул

Обозначение	Резба	за външен Ø на маркуча	L1 (mm)	L2 мин (mm)	L2 макс (mm)	SW
K- 07 40 06 99	G 1/8	4 mm	46,5	28,9	31,2	12 mm
K- 07 40 07 00	G 1/8	6 mm	53,7	41,1	46,8	14 mm
K- 07 40 07 01	G 1/8	8 mm	58,1	41,7	47,4	14 mm
K- 07 40 06 97	G 1/4	6 mm	55,1	40,8	47,0	14 mm
K- 07 40 06 98	G 1/4	8 mm	59,6	44,8	50,8	17 mm
K- 07 40 06 95	G 1/4	10 mm	70,3	47,4	54,0	17 mm
K- 07 40 06 96	G 1/4	12 mm	80,6	50,3	55,3	21 mm
K- 07 40 07 04	G 3/8	8 mm	61,0	44,3	50,4	17 mm
K- 07 40 07 02	G 3/8	10 mm	71,6	48,5	55,3	20 mm
K- 07 40 07 03	G 3/8	12 mm	81,3	51,8	57,1	21 mm
K- 07 40 06 93	G 1/2	10 mm	76,0	48,3	54,5	19 mm
K- 07 40 06 94	G 1/2	12 mm	85,9	51,5	56,8	24 mm