

# K-DRG PNEU FERNGEST MULTIFIX

Pressure regulators with pneumatic remote control

**HANSA FLEX**

## Свойства

|                                      |   |
|--------------------------------------|---|
| входящо налягане                     | Max. 16 bar   |
| изходящо налягане                    | corresponds to the set pressure of the pilot pressure regulator |
| температура на средата               | max. 60 °C  |
| околна температура                   | Max. 60 °C  |
| уплътняващ материал                  | NBR   |
| корпус                               | Die-cast zinc, Aluminium for G 1 variant                        |
| измерване на стойността на протичане | At P1 = 8 bar, P2 = 6 bar and pressure drop $\Delta p = 1$ bar  |
| съединение управляващ въздух         | G 1/8   |

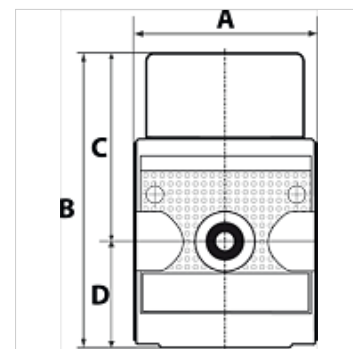

## Указание

Други данни при запитване.

## Описание

Diaphragm pressure regulator, self-relieving, with pneumatic remote control. The pressure is set with a pilot pressure regulator (1:1 ratio). Either a standard or a precision pressure regulator can be used to regulate the pilot pressure.

## Артикул

| Обозначение    | Резба | протичане (L/min) | A (mm) | B        | C (mm) | D (mm) |
|----------------|-------|-------------------|--------|----------|--------|--------|
| K- 07 25 19 56 | G 1/4 | 1800              | 48,0   | 75,0 mm  | 48,0   | 27,0   |
| K- 07 25 19 57 | G 1/2 | 4800              | 69,0   | 94,0 mm  | 59,0   | 35,0   |
| K- 07 25 19 58 | G 1   | 12500             | 100,0  | 112,0 mm | 60,0   | 52,0   |

## Резервни части

|                           |                                 |
|---------------------------|---------------------------------|
| K-HALTERBAUSATZ MULTIFIX  | Holder                          |
| K-KOPPELPAKET MEHR        | Coupling packet                 |
| K-VERSCHLEI-SATZ MULTIFIX | Set of wearing parts »multifix« |