

Vlastnosti

| | |
|-----------------------|---|
| Přípoj 1 | Vnější závit NPT |
| Tvar těsnění 1 | s těsněním na závit |
| Přípoj 2 | metrický vnější cylindrický závit |
| Tvar těsnění 2 | Vnitřní kužel 24° |
| Konstrukce | hrdlové šroubení |
| Provedení | přímé |
| Norma | DIN 2353 ISO 8434-1 |
| Obsah dodávky | hrdlo (bez přesuvné matice a zářezného kroužku) |
| Materiál | Ušlechtilá ocel |

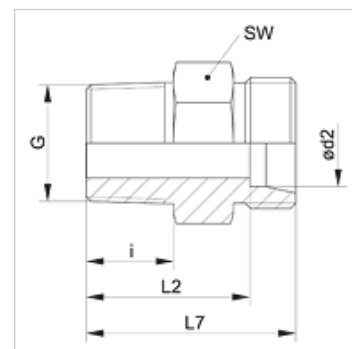

Upozornění

Upozornění k montáži, vestavbě, tlakovému zatížení a povoleným provozním teplotám si prosím vyhledejte v technických dokumentacích fitinkových šroubení.

Výrobek

| Označení | Typová řada | Provozní tlak v barech | Ø d2 (mm) | G | i (mm) | L2 (mm) | L7 (mm) | SW (mm) |
|-----------------------|-------------|------------------------|-----------|------------------|--------|---------|---------|---------|
| XVN 04 LL VA | LL | PN 100 | 4 | 1/8" -27 NPT | 10,0 | 18,0 | 22,0 | 11 |
| XVN 06 LL VA | LL | PN 100 | 6 | 1/8" -27 NPT | 10,0 | 16,5 | 22,0 | 11 |
| XVN 08 LL VA | LL | PN 100 | 8 | 1/8" -27 NPT | 10,0 | 18,5 | 24,0 | 12 |
| XVN NW 04 HL VA | L | PN 315 | 6 | 1/8" -27 NPT | 10,0 | 17,0 | 24,0 | 12 |
| XVN NW 04 HL 1/4 VA | L | PN 315 | 6 | 1/4" -18 NPT | 15,0 | 23,0 | 30,0 | 17 |
| XVN NW 04 HL 3/8 VA | L | PN 315 | 6 | 3/8" -18 NPT | 15,3 | 24,0 | 31,0 | 19 |
| XVN NW 04 HL 1/2 VA | L | PN 315 | 6 | 1/2" -14 NPT | 20,0 | 29,0 | 36,0 | 24 |
| XVN NW 06 HL 1/8 VA | L | PN 315 | 8 | 1/8" -27 NPT | 10,0 | 18,0 | 25,0 | 17 |
| XVN NW 06 HL VA | L | PN 315 | 8 | 1/4" -18 NPT | 15,0 | 23,0 | 30,0 | 17 |
| XVN NW 06 HL 3/8 VA | L | PN 315 | 8 | 3/8" -18 NPT | 15,3 | 24,0 | 31,0 | 19 |
| XVN NW 06 HL 1/2 VA | L | PN 315 | 8 | 1/2" -14 NPT | 20,0 | 29,0 | 36,0 | 24 |
| XVN NW 08 HL 1/8 VA | L | PN 315 | 10 | 1/8" -27 NPT | 10,0 | 19,0 | 26,0 | 17 |
| XVN NW 08 HL VA | L | PN 315 | 10 | 1/4" -18 NPT | 15,0 | 24,0 | 31,0 | 17 |
| XVN NW 08 HL 3/8 VA | L | PN 315 | 10 | 3/8" -18 NPT | 15,3 | 25,0 | 32,0 | 19 |
| XVN NW 08 HL 1/2 VA | L | PN 315 | 10 | 1/2" -14 NPT | 20,0 | 30,0 | 37,0 | 24 |
| XVN NW 08 HL 3/4 VA | L | PN 315 | 10 | 3/4" -14 NPT | 20,2 | 31,0 | 38,0 | 27 |
| XVN NW 10 HL 1/8 VA | L | PN 315 | 12 | 1/8" -27 NPT | 10,0 | 19,5 | 26,5 | 19 |
| XVN NW 10 HL 1/4 VA | L | PN 315 | 12 | 1/4" -18 NPT | 15,0 | 25,0 | 32,0 | 19 |
| XVN NW 10 HL VA | L | PN 315 | 12 | 3/8" -18 NPT | 15,3 | 25,0 | 32,0 | 19 |
| XVN NW 10 HL 1/2 VA | L | PN 315 | 12 | 1/2" -14 NPT | 20,0 | 30,0 | 37,0 | 24 |
| XVN NW 10 HL 3/4 VA | L | PN 315 | 12 | 3/4" -14 NPT | 20,2 | 31,0 | 38,0 | 27 |
| XVN NW 13 HL 1/4 VA | L | PN 315 | 15 | 1/4" -18 NPT | 15,0 | 26,0 | 33,0 | 24 |
| XVN NW 13 HL 3/8 VA | L | PN 315 | 15 | 3/8" -18 NPT | 15,3 | 26,5 | 33,5 | 24 |
| XVN NW 13 HL VA | L | PN 315 | 15 | 1/2" -14 NPT | 20,0 | 31,0 | 38,0 | 24 |
| XVN NW 13 HL 3/4 VA | L | PN 315 | 15 | 3/4" -14 NPT | 20,2 | 32,0 | 39,0 | 27 |
| XVN NW 13 HL 1 VA | L | PN 315 | 15 | 1" -11,5 NPT | 25,0 | 37,5 | 44,5 | 36 |
| XVN NW 16 HL 3/8 VA | L | PN 315 | 18 | 3/8" -18 NPT | 15,3 | 27,0 | 34,5 | 27 |
| XVN NW 16 HL VA | L | PN 315 | 18 | 1/2" -14 NPT | 20,0 | 31,5 | 39,0 | 27 |
| XVN NW 16 HL 3/4 VA | L | PN 315 | 18 | 3/4" -14 NPT | 20,2 | 31,5 | 39,0 | 27 |
| XVN NW 16 HL 1 VA | L | PN 315 | 18 | 1" -11,5 NPT | 25,0 | 37,0 | 44,5 | 36 |
| XVN NW 20 HL 3/8 VA | L | PN 160 | 22 | 3/8" -18 NPT | 15,3 | 29,0 | 36,5 | 32 |
| XVN NW 20 HL 1/2 VA | L | PN 160 | 22 | 1/2" -14 NPT | 20,0 | 33,5 | 41,0 | 32 |
| XVN NW 20 HL VA | L | PN 160 | 22 | 3/4" -14 NPT | 20,2 | 33,5 | 41,0 | 32 |
| XVN NW 20 HL 1 VA | L | PN 160 | 22 | 1" -11,5 NPT | 25,0 | 39,0 | 46,5 | 36 |
| XVN NW 20 HL 1 1/4 VA | L | PN 160 | 22 | 1.1/4" -11,5 NPT | 25,6 | 41,5 | 49,0 | 46 |
| XVN NW 25 HL 1/2 VA | L | PN 160 | 28 | 1/2" -14 NPT | 20,0 | 34,5 | 42,0 | 41 |
| XVN NW 25 HL 3/4 VA | L | PN 160 | 28 | 3/4" -14 NPT | 20,2 | 34,5 | 42,0 | 41 |
| XVN NW 25 HL VA | L | PN 160 | 28 | 1" -11,5 NPT | 25,0 | 39,5 | 47,0 | 41 |
| XVN NW 25 HL 1 1/4 VA | L | PN 160 | 28 | 1.1/4" -11,5 NPT | 25,6 | 41,5 | 49,0 | 46 |
| XVN NW 32 HL 3/4 VA | L | PN 160 | 35 | 3/4" -14 NPT | 20,2 | 35,0 | 45,5 | 46 |
| XVN NW 32 HL 1 VA | L | PN 160 | 35 | 1" -11,5 NPT | 25,0 | 40,0 | 50,5 | 46 |
| XVN NW 32 HL VA | L | PN 160 | 35 | 1.1/4" -11,5 NPT | 25,6 | 40,5 | 51,0 | 46 |
| XVN NW 32 HL 1 1/2 VA | L | PN 160 | 35 | 1.1/2" -11,5 NPT | 26,0 | 42,5 | 53,0 | 55 |



Výrobek

| Označení | Typová řada | Provozní tlak v barech | Ø d2 (mm) | G | i (mm) | L2 (mm) | L7 (mm) | SW (mm) |
|-----------------------|-------------|------------------------|-----------|------------------|--------|---------|---------|---------|
| XVN NW 40 HL 1 VA | L | PN 160 | 42 | 1" -11,5 NPT | 25,0 | 41,0 | 52,0 | 55 |
| XVN NW 40 HL 1 1/4 VA | L | PN 160 | 42 | 1.1/4" -11,5 NPT | 25,6 | 41,5 | 52,5 | 55 |
| XVN NW 40 HL VA | L | PN 160 | 42 | 1.1/2" -11,5 NPT | 26,0 | 42,0 | 53,0 | 55 |
| XVN NW 03 HS 1/8 VA | S | PN 630 | 6 | 1/8" -27 NPT | 10,0 | 23,0 | 30,0 | 17 |
| XVN NW 03 HS VA | S | PN 630 | 6 | 1/4" -18 NPT | 15,0 | 28,0 | 35,0 | 17 |
| XVN NW 03 HS 1/2 VA | S | PN 630 | 6 | 1/2" -14 NPT | 20,0 | 35,0 | 42,0 | 24 |
| XVN NW 03 HS 3/8 VA | S | PN 630 | 6 | 3/8" -18 NPT | 15,3 | 28,0 | 35,0 | 19 |
| XVN NW 04 HS 1/8 VA | S | PN 630 | 8 | 1/8" -27 NPT | 10,0 | 23,0 | 30,0 | 17 |
| XVN NW 04 HS 3/8 VA | S | PN 630 | 8 | 3/8" -18 NPT | 15,3 | 28,0 | 35,0 | 19 |
| XVN NW 04 HS VA | S | PN 630 | 8 | 1/4" -18 NPT | 15,0 | 28,0 | 35,0 | 17 |
| XVN NW 04 HS 1/2 VA | S | PN 630 | 8 | 1/2" -14 NPT | 20,0 | 35,0 | 42,0 | 24 |
| XVN NW 06 HS 1/8 VA | S | PN 630 | 10 | 1/8" -27 NPT | 10,0 | 22,5 | 30,0 | 19 |
| XVN NW 06 HS 1/4 VA | S | PN 630 | 10 | 1/4" -18 NPT | 15,0 | 27,5 | 35,0 | 19 |
| XVN NW 06 HS VA | S | PN 630 | 10 | 3/8" -18 NPT | 15,3 | 27,5 | 35,0 | 19 |
| XVN NW 06 HS 1/2 VA | S | PN 400 | 10 | 1/2" -14 NPT | 20,0 | 34,5 | 42,0 | 24 |
| XVN NW 06 HS 3/4 VA | S | PN 630 | 10 | 3/4" -14 NPT | 20,2 | 36,5 | 44,0 | 32 |
| XVN NW 08 HS 1/4 VA | S | PN 630 | 12 | 1/4" -18 NPT | 15,0 | 29,0 | 36,5 | 22 |
| XVN NW 08 HS 3/4 VA | S | PN 630 | 12 | 3/4" -14 NPT | 20,0 | 36,5 | 44,0 | 32 |
| XVN NW 08 HS VA | S | PN 630 | 12 | 3/8" -18 NPT | 15,3 | 29,5 | 37,0 | 22 |
| XVN NW 08 HS 1/2 VA | S | PN 630 | 12 | 1/2" -14 NPT | 20,0 | 34,5 | 42,0 | 24 |
| XVN NW 10 HS 3/8 VA | S | PN 630 | 14 | 3/8" -18 NPT | 15,3 | 31,5 | 39,5 | 24 |
| XVN NW 10 HS VA | S | PN 630 | 14 | 1/2" -14 NPT | 20,0 | 36,0 | 44,0 | 24 |
| XVN NW 10 HS 3/4 VA | S | PN 630 | 14 | 3/4" -14 NPT | 20,2 | 38,0 | 46,0 | 32 |
| XVN NW 10 HS 1 VA | S | PN 630 | 14 | 1" -11,5 NPT | 25,0 | 45,0 | 53,0 | 41 |
| XVN NW 13 HS VA | S | PN 400 | 16 | 1/2" -14 NPT | 20,0 | 35,5 | 44,0 | 27 |
| XVN NW 13 HS 3/8 VA | S | PN 400 | 16 | 3/8" -18 NPT | 15,3 | 31,0 | 39,5 | 27 |
| XVN NW 13 HS 3/4 VA | S | PN 400 | 16 | 3/4" -14 NPT | 20,2 | 37,5 | 46,0 | 32 |
| XVN NW 13 HS 1 VA | S | PN 400 | 16 | 1" -11,5 NPT | 25,0 | 44,5 | 53,0 | 41 |
| XVN NW 16 HS 3/8 VA | S | PN 400 | 20 | 3/8" -18 NPT | 15,3 | 33,0 | 43,5 | 32 |
| XVN NW 16 HS 1/2 VA | S | PN 400 | 20 | 1/2" -14 NPT | 20,0 | 37,5 | 48,0 | 32 |
| XVN NW 16 HS VA | S | PN 400 | 20 | 3/4" -14 NPT | 20,2 | 37,5 | 48,0 | 32 |
| XVN NW 16 HS 1 VA | S | PN 400 | 20 | 1" -11,5 NPT | 25,0 | 44,5 | 55,0 | 41 |
| XVN NW 16 HS 1 1/4 VA | S | PN 400 | 20 | 1.1/4" -11,5 NPT | 25,6 | 45,5 | 56,0 | 46 |
| XVN NW 20 HS 3/4 VA | S | PN 400 | 25 | 3/4" -14 NPT | 20,2 | 40,0 | 52,0 | 41 |
| XVN NW 20 HS VA | S | PN 400 | 25 | 1" -11,5 NPT | 25,0 | 45,0 | 57,0 | 41 |
| XVN NW 20 HS 1/2 VA | S | PN 400 | 25 | 1/2" -14 NPT | 20,0 | 40,0 | 52,0 | 41 |
| XVN NW 20 HS 1 1/4 VA | S | PN 400 | 25 | 1.1/4" -11,5 NPT | 25,6 | 46,0 | 58,0 | 46 |
| XVN NW 20 HS 1 1/2 VA | S | PN 400 | 25 | 1.1/2" -11,5 NPT | 26,0 | 49,0 | 61,0 | 55 |
| XVN NW 25 HS VA | S | PN 400 | 30 | 1.1/4" -11,5 NPT | 25,6 | 46,5 | 60,0 | 46 |
| XVN NW 25 HS 3/4 VA | S | PN 400 | 30 | 3/4" -14 NPT | 20,2 | 41,0 | 54,5 | 46 |
| XVN NW 25 HS 1 VA | S | PN 400 | 30 | 1" -11,5 NPT | 25,0 | 46,0 | 59,5 | 46 |
| XVN NW 25 HS 1 1/2 VA | S | PN 400 | 30 | 1.1/2" -11,5 NPT | 26,0 | 49,5 | 63,0 | 55 |
| XVN NW 32 HS 1 VA | S | PN 315 | 38 | 1" -11,5 NPT | 25,0 | 48,0 | 64,0 | 55 |
| XVN NW 32 HS VA | S | PN 315 | 38 | 1.1/2" -11,5 NPT | 26,0 | 49,0 | 65,0 | 55 |
| XVN NW 32 HS 1 1/4 VA | S | PN 315 | 38 | 1.1/4" -11,5 NPT | 25,6 | 48,5 | 64,5 | 55 |

typová řada: LL = velmi lehká L = lehká S = robustní - PN = nominální tlak PB = max. provozní tlak - Ø d2 = vnější průměr trubky

Varianty produktu

| | |
|-------|-----------------------------------|
| XVN | Šroubení k zašroubování, Ocel |
| VN VA | Hrdlové šroubení, Ušlechtilá ocel |