

Vlastnosti

| | |
|-----------------------|-------------------------------------------------|
| Přípoj 1 | Vnější závit kuželový BSPT |
| Tvar těsnění 1 | s těsněním na závit |
| Přípoj 2 | metrický vnější cylindrický závit |
| Tvar těsnění 2 | Vnitřní kužel 24° |
| Konstrukce | hrdlové šroubení |
| Provedení | přímé |
| Norma | DIN 3901 |
| Obsah dodávky | hrdlo (bez přesuvné matice a zářezného kroužku) |
| Materiál | Ušlechtilá ocel |

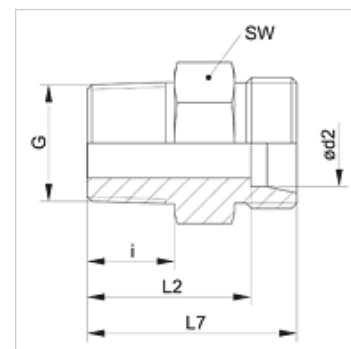

Upozornění

Upozornění k montáži, vestavbě, tlakovému zatížení a povoleným provozním teplotám si prosím vyhledejte v technických dokumentacích fitinkových šroubení.

Výrobek

| Označení | Typová řada | Provozní tlak v barech | Ø d2 (mm) | G | i (mm) | L2 (mm) | L7 (mm) | SW (mm) |
|------------------------|-------------|------------------------|-----------|------------|--------|---------|---------|---------|
| XVR 04 LL VA | LL | PN 100 | 4 | R 1/8" K | 8,0 | 16,0 | 20,0 | 11 |
| XVR 06 LL VA | LL | PN 100 | 6 | R 1/8" K | 8,0 | 14,5 | 20,0 | 11 |
| XVR 06 LL 1/4 VA | LL | PN 100 | 6 | R 1/4" K | 12,0 | 14,5 | 20,0 | 12 |
| XVR 08 LL 1/4 VA | LL | PN 100 | 8 | R 1/4" K | 12,0 | 20,5 | 26,0 | 14 |
| XVR 08 LL VA | LL | PN 100 | 8 | R 1/8" K | 8,0 | 16,5 | 22,0 | 12 |
| XVRK NW 04 HL VA | L | PN 315 | 6 | R 1/8" K | 10,5 | 17,5 | 24,5 | 12 |
| XVRK NW 04 HL 1/4 VA | L | PN 315 | 6 | R 1/4" K | 14,0 | 22,0 | 29,0 | 17 |
| XVRK NW 04 HL 3/8 VA | L | PN 315 | 6 | R 1/2" K | 14,5 | 23,5 | 30,5 | 19 |
| XVRK NW 04 HL 1/2 VA | L | PN 315 | 6 | R 1/2" K | 18,5 | 27,5 | 34,5 | 22 |
| XVRK NW 06 HL 1/8 VA | L | PN 315 | 8 | R 1/8" K | 10,5 | 18,5 | 25,5 | 14 |
| XVRK NW 06 HL VA | L | PN 315 | 8 | R 1/4" K | 14,0 | 22,0 | 29,0 | 17 |
| XVRK NW 06 HL 3/8 VA | L | PN 315 | 8 | R 3/8" K | 14,5 | 22,5 | 30,5 | 19 |
| XVRK NW 06 HL 1/2 VA | L | PN 315 | 8 | R 1/2" K | 18,5 | 27,5 | 34,5 | 22 |
| XVRK NW 08 HL VA | L | PN 315 | 10 | R 1/4" K | 14,0 | 23,0 | 30,0 | 17 |
| XVRK NW 08 HL 1/8 VA | L | PN 315 | 10 | R 1/8" K | 10,5 | 19,5 | 26,5 | 17 |
| XVRK NW 08 HL 3/8 VA | L | PN 315 | 10 | R 3/8" K | 14,5 | 24,5 | 31,5 | 19 |
| XVRK NW 08 HL 1/2 VA | L | PN 315 | 10 | R 1/2" K | 18,5 | 28,5 | 35,5 | 22 |
| XVRK NW 10 HL VA | L | PN 315 | 12 | R 3/8" K | 14,5 | 24,5 | 31,5 | 19 |
| XVRK NW 10 HL 1/8 VA | L | PN 315 | 12 | R 1/8" K | 10,5 | 20,5 | 27,5 | 19 |
| XVRK NW 10 HL 1/4 VA | L | PN 315 | 12 | R 1/4" K | 14,0 | 24,0 | 31,0 | 19 |
| XVRK NW 10 HL 1/2 VA | L | PN 315 | 12 | R 1/2" K | 18,5 | 28,5 | 35,5 | 24 |
| XVRK NW 10 HL 3/4 VA | L | PN 315 | 12 | R 3/4" K | 20,0 | 31,0 | 38,0 | 32 |
| XVRK NW 13 HL 1/4 VA | L | PN 315 | 15 | R 1/4" K | 14,0 | 25,0 | 32,0 | 24 |
| XVRK NW 13 HL VA | L | PN 315 | 15 | R 1/2" K | 18,5 | 29,5 | 36,5 | 24 |
| XVRK NW 13 HL 3/8 VA | L | PN 315 | 15 | R 3/8" K | 14,5 | 25,5 | 24,0 | 33 |
| XVRK NW 13 HL 3/4 VA | L | PN 315 | 15 | R 3/4" K | 20,0 | 32,0 | 39,0 | 32 |
| XVRK NW 16 HL VA | L | PN 315 | 18 | R 1/2" K | 18,5 | 30,0 | 37,5 | 27 |
| XVRK NW 16 HL 3/8 VA | L | PN 315 | 18 | R 3/8" K | 14,5 | 26,0 | 33,5 | 27 |
| XVRK NW 16 HL 3/4 VA | L | PN 160 | 18 | R 3/4" K | 20,0 | 31,5 | 39,0 | 32 |
| XVRK NW 20 HL 3/8 VA | L | PN 160 | 22 | R 3/8" K | 14,5 | 28,0 | 35,5 | 32 |
| XVRK NW 20 HL VA | L | PN 160 | 22 | R 3/4" K | 20,0 | 33,5 | 41,0 | 32 |
| XVRK NW 20 HL 1/2 VA | L | PN 160 | 22 | R 1/2" K | 18,5 | 32,0 | 39,5 | 32 |
| XVRK NW 20 HL 1 VA | L | PN 160 | 22 | R 1" K | 24,0 | 38,5 | 46,0 | 41 |
| XVRK NW 25 HL 1/2 VA | L | PN 160 | 28 | R 1/2" K | 18,5 | 33,0 | 40,5 | 41 |
| XVRK NW 25 HL 3/4 VA | L | PN 160 | 28 | R 3/4" K | 20,0 | 34,5 | 42,0 | 41 |
| XVRK NW 25 HL VA | L | PN 160 | 28 | R 1" K | 24,0 | 38,5 | 46,0 | 41 |
| XVRK NW 25 HL 1 1/4 VA | L | PN 160 | 28 | R 1.1/4" K | 26,0 | 43,5 | 51,0 | 46 |
| XVRK NW 32 HL VA | L | PN 160 | 35 | R 1.1/4" K | 26,0 | 42,5 | 53,0 | 46 |
| XVRK NW 32 HL 1 VA | L | PN 160 | 35 | R 1" K | 24,0 | 40,5 | 51,0 | 46 |
| XVRK NW 40 HL VA | L | PN 160 | 42 | R 1.1/2" K | 27,0 | 43,0 | 54,0 | 55 |
| XVRK NW 40 HL 1 1/4 VA | L | PN 160 | 42 | R 1.1/4" K | 26,0 | 42,0 | 53,0 | 55 |
| XVRK NW 03 HS VA | S | PN 400 | 6 | R 1/4" K | 14,0 | 27,0 | 34,0 | 17 |



Výrobek

| Označení | Typová řada | Provozní tlak v barech | Ø d2 (mm) | G | i (mm) | L2 (mm) | L7 (mm) | SW (mm) |
|----------------------|-------------|------------------------|-----------|------------|--------|---------|---------|---------|
| XVRK NW 04 HS VA | S | PN 400 | 8 | R 1/4" K | 14,0 | 27,0 | 34,0 | 17 |
| XVRK NW 04 HS 3/8 VA | S | PN 160 | 8 | R 3/8" K | 14,5 | 27,5 | 34,5 | 19 |
| XVRK NW 06 HS VA | S | PN 400 | 10 | R 3/8" K | 14,5 | 27,0 | 34,5 | 19 |
| XVRK NW 06 HS 1/4 VA | S | PN 400 | 10 | R 1/4" K | 14,0 | 26,5 | 34,0 | 19 |
| XVRK NW 08 HS VA | S | PN 400 | 12 | R 3/8" K | 14,5 | 29,0 | 36,5 | 22 |
| XVRK NW 08 HS 1/2 VA | S | PN 400 | 12 | R 1/2" K | 18,5 | 33,0 | 40,5 | 22 |
| XVRK NW 10 HS VA | S | PN 400 | 14 | R 1/2" K | 18,5 | 34,5 | 42,5 | 24 |
| XVRK NW 13 HS VA | S | PN 400 | 16 | R 1/2" K | 18,5 | 34,0 | 42,5 | 27 |
| XVRK NW 16 HS VA | S | PN 400 | 20 | R 3/4" K | 20,0 | 37,5 | 48,0 | 32 |
| XVRK NW 16 HS 1/2 VA | S | PN 400 | 20 | R 1/2" K | 18,5 | 36,0 | 46,5 | 32 |
| XVRK NW 20 HS VA | S | PN 400 | 25 | R 1" K | 24,0 | 43,0 | 55,0 | 41 |
| XVRK NW 25 HS VA | S | PN 250 | 30 | R 1.1/4" K | 26,0 | 45,5 | 59,0 | 46 |

typová řada: LL = velmi lehká L = lehká S = robustní - PN = nominální tlak PB = max. provozní tlak - Ø d2 = vnější průměr trubky

Varianty produktu

| | |
|--------|-----------------------------------|
| XVRK | Šroubení k zašroubování, Ocel |
| VRK VA | Hrdlové šroubení, Ušlechtilá ocel |