

# W90 HN HJ

Hrdlo k zašroubování, úhel 90°

**HANSA FLEX**

## Vlastnosti

|                   |                      |
|-------------------|----------------------|
| Přípoj 1          | Vnější závit NPT     |
| Tvar těsnění 1    | s těsněním na závit  |
| Přípoj 2          | Vnější závit UN/UNF  |
| Tvar těsnění 2    | Vnější kužel 74°     |
| Konstrukce        | Hrdlo k zašroubování |
| Provedení         | úhel 90°             |
| Materiál          | Ocel                 |
| Povrchová ochrana | galvanicky potažený  |

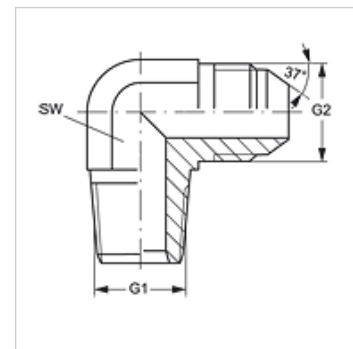

## Výrobek

| Označení        | G1               | G2             | SW<br>(mm) |
|-----------------|------------------|----------------|------------|
| W90 HN 02 HJ    | 1/8" -27 NPT     | 5/16" -24 UN   | 8          |
| W90 HN 02 HJ 04 | 1/8" -27 NPT     | 7/16" -20 UNF  | 11         |
| W90 HN 02 HJ 05 | 1/8" -27 NPT     | 1/2" -20 UNF   | 13         |
| W90 HN 02 HJ 06 | 1/8" -27 NPT     | 9/16" -18 UNF  | 14         |
| W90 HN 04 HJ    | 1/4" -18 NPT     | 7/16" -20 UNF  | 14         |
| W90 HN 04 HJ 05 | 1/4" -18 NPT     | 1/2" -20 UNF   | 14         |
| W90 HN 04 HJ 06 | 1/4" -18 NPT     | 9/16" -18 UNF  | 14         |
| W90 HN 04 HJ 08 | 1/4" -18 NPT     | 3/4" -16 UNF   | 19         |
| W90 HN 06 HJ 04 | 3/8" -18 NPT     | 7/16" -20 UNF  | 19         |
| W90 HN 06 HJ    | 3/8" -18 NPT     | 9/16" -18 UNF  | 19         |
| W90 HN 06 HJ 05 | 3/8" -18 NPT     | 1/2" -20 UNF   | 19         |
| W90 HN 06 HJ 08 | 3/8" -18 NPT     | 3/4" -16 UNF   | 19         |
| W90 HN 06 HJ 10 | 3/8" -18 NPT     | 7/8" -14 UNF   | 22         |
| W90 HN 08 HJ 04 | 1/2" -14 NPT     | 7/16" -20 UNF  | 22         |
| W90 HN 08 HJ    | 1/2" -14 NPT     | 3/4" -16 UNF   | 22         |
| W90 HN 08 HJ 05 | 1/2" -14 NPT     | 1/2" -20 UNF   | 19         |
| W90 HN 08 HJ 06 | 1/2" -14 NPT     | 9/16" -18 UNF  | 22         |
| W90 HN 08 HJ 10 | 1/2" -14 NPT     | 7/8" -14 UNF   | 22         |
| W90 HN 08 HJ 12 | 1/2" -14 NPT     | 1.1/16" -12 UN | 27         |
| W90 HN 12 HJ    | 3/4" -14 NPT     | 1.1/16" -12 UN | 27         |
| W90 HN 12 HJ 06 | 3/4" -14 NPT     | 9/16" -18 UNF  | 27         |
| W90 HN 12 HJ 08 | 3/4" -14 NPT     | 3/4" -16 UNF   | 27         |
| W90 HN 12 HJ 10 | 3/4" -14 NPT     | 7/8" -14 UNF   | 27         |
| W90 HN 12 HJ 14 | 3/4" -14 NPT     | 1.3/16" -12 UN | 31         |
| W90 HN 12 HJ 16 | 3/4" -14 NPT     | 1.5/16" -12 UN | 33         |
| W90 HN 16 HJ    | 1" -11,5 NPT     | 1.5/16" -12 UN | 33         |
| W90 HN 16 HJ 12 | 1" -11,5 NPT     | 1.1/16" -12 UN | 33         |
| W90 HN 16 HJ 20 | 1" -11,5 NPT     | 1.5/8" -12 UN  | 41         |
| W90 HN 20 HJ 16 | 1.1/4" -11,5 NPT | 1.5/16" -12 UN | 45         |
| W90 HN 20 HJ    | 1.1/4" -11,5 NPT | 1.5/8" -12 UN  | 45         |
| W90 HN 20 HJ 24 | 1.1/4" -11,5 NPT | 1.7/8" -12 UN  | 48         |
| W90 HN 24 HJ 20 | 1.1/2" -11,5 NPT | 1.5/8" -12 UN  | 48         |
| W90 HN 24 HJ    | 1.1/2" -11,5 NPT | 1.7/8" -12 UN  | 48         |
| W90 HN 32 HJ    | 2" -11,5 NPT     | 2.1/2" -12 UN  | 64         |

SW = otvor klíče

## Varianty produktu

W90 HN HJ VA Hrdlo k zašroubování, úhel 90°, Ušlechtilá ocel