

Vlastnosti

| | |
|--------------------------|---------------------|
| Přípoj 1 | Vnější závit NPT |
| Tvar těsnění 1 | s těsněním na závit |
| Přípoj 2 | Vnější závit NPT |
| Tvar těsnění 2 | s těsněním na závit |
| Konstrukce | Spojovací hrdlo |
| Provedení | přímé |
| Materiál | Ocel |
| Povrchová ochrana | galvanicky potažený |

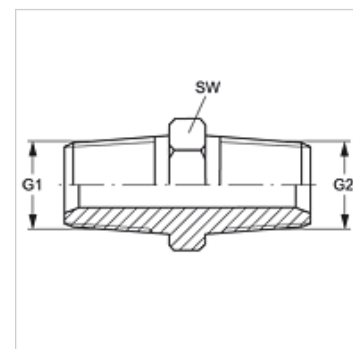

Výrobek

| Označení | G1 | G2 | SW (mm) |
|------------|------------------|------------------|------------|
| G HN 02 | 1/8" -27 NPT | 1/8" -27 NPT | 11 |
| G 04 HN 02 | 1/4" -18 NPT | 1/8" -27 NPT | 14 |
| G HN 04 | 1/4" -18 NPT | 1/4" -18 NPT | 14 |
| G 06 HN 02 | 3/8" -18 NPT | 1/8" -27 NPT | 19 |
| G 06 HN 04 | 3/8" -18 NPT | 1/4" -18 NPT | 19 |
| G HN 06 | 3/8" -18 NPT | 3/8" -18 NPT | 19 |
| G 08 HN 04 | 1/2" -14 NPT | 1/4" -18 NPT | 22 |
| G 08 HN 06 | 1/2" -14 NPT | 3/8" -18 NPT | 22 |
| G HN 08 | 1/2" -14 NPT | 1/2" -14 NPT | 22 |
| G 12 HN 04 | 3/4" -14 NPT | 1/4" -18 NPT | 27 |
| G 12 HN 06 | 3/4" -14 NPT | 3/8" -18 NPT | 27 |
| G 12 HN 08 | 3/4" -14 NPT | 1/2" -14 NPT | 27 |
| G HN 12 | 3/4" -14 NPT | 3/4" -14 NPT | 27 |
| G 12 HN 16 | 3/4" -14 NPT | 1" -11,5 NPT | 36 |
| G 16 HN 08 | 1" -11,5 NPT | 1/2" -14 NPT | 36 |
| G HN 16 | 1" -11,5 NPT | 1" -11,5 NPT | 36 |
| G 20 HN 16 | 1.1/4" -11,5 NPT | 1" -11,5 NPT | 46 |
| G HN 20 | 1.1/4" -11,5 NPT | 1.1/4" -11,5 NPT | 46 |
| G 24 HN 08 | 1.1/2" -11,5 NPT | 1/2" -14 NPT | 50 |
| G 24 HN 16 | 1.1/2" -11,5 NPT | 1" -11,5 NPT | 50 |
| G 24 HN 20 | 1.1/2" -11,5 NPT | 1.1/4" -11,5 NPT | 50 |
| G HN 24 | 1.1/2" -11,5 NPT | 1.1/2" -11,5 NPT | 50 |
| G 32 HN 24 | 2" -11,5 NPT | 1.1/2" -11,5 NPT | 65 |
| G HN 32 | 2" -11,5 NPT | 2" -11,5 NPT | 65 |
| G HN 40 | 2.1/2" -8 NPT | 2.1/2" -8 NPT | 70 |

SW = otvor klíče

Varianty produktu

G HN VA Spojovací hrdlo, Ušlechtilá ocel