

# K-XV RD 6-KANT

Double nipples, unequal, hexagonal

**HANSA FLEX**

## Vlastnosti

|               |                              |
|---------------|------------------------------|
| Pracovní tlak | Max. 20 bar                  |
| Závit vnější  | Parallel to DIN EN ISO 228-1 |
| Materiál      | Stainless steel 1.4408       |

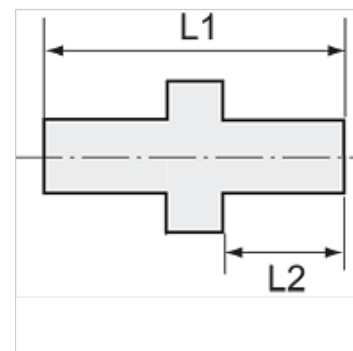
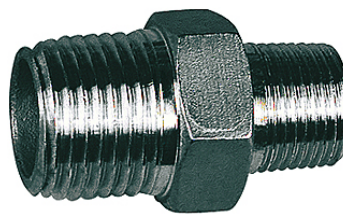

## Upozornění

The dimensions of the standard screw fittings may change slightly during the life of the catalogue as a result of optimisation processes.

Další údaje na dotaz.

## Výrobek

| Označení       | Závit 1 vnější | Závit 2 vnější | L1<br>(mm) | L2<br>(mm) | SW    |
|----------------|----------------|----------------|------------|------------|-------|
| K- 07 40 12 27 | G 1/4          | G 1/8          | 30,4       | 11,0       | 15 mm |
| K- 07 40 12 28 | G 3/8          | G 1/8          | 34,2       | 12,0       | 20 mm |
| K- 07 40 12 29 | G 3/8          | G 1/4          | 35,8       | 12,8       | 20 mm |
| K- 07 40 12 30 | G 1/2          | G 1/4          | 38,0       | 13,0       | 24 mm |
| K- 07 40 12 31 | G 1/2          | G 3/8          | 40,0       | 15,0       | 24 mm |
| K- 07 40 12 32 | G 3/4          | G 3/8          | 41,0       | 16,0       | 27 mm |
| K- 07 40 12 33 | G 3/4          | G 1/2          | 42,9       | 16,0       | 29 mm |
| K- 07 40 12 34 | G 1            | G 1/2          | 46,0       | 17,0       | 36 mm |
| K- 07 40 12 35 | G 1            | G 3/4          | 46,0       | 16,5       | 36 mm |
| K- 07 40 12 36 | G 1 1/4        | G 3/4          | 50,0       | 17,5       | 45 mm |
| K- 07 40 12 37 | G 1 1/4        | G 1            | 51,0       | 18,5       | 45 mm |
| K- 07 40 12 38 | G 1 1/2        | G 1            | 52,0       | 18,5       | 51 mm |
| K- 07 40 12 39 | G 1 1/2        | G 1 1/4        | 55,0       | 20,7       | 51 mm |
| K- 07 40 12 40 | G 2            | G 1            | 58,0       | 20,0       | 62 mm |
| K- 07 40 12 41 | G 2            | G 1 1/2        | 60,0       | 21,5       | 63 mm |