

K-MUFFEN VALUE LINE MS NI

Sockets

HANSA FLEX

Vlastnosti

Max. provozní tlak 60 bar

Max. provozní teplota 150 °C

Materiál poniklovaná mosaz

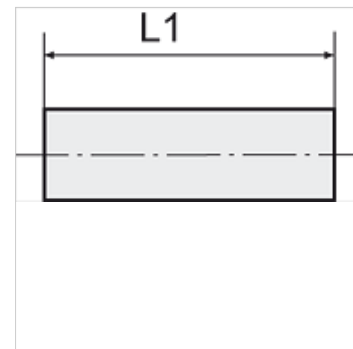

Upozornění

The dimensions of the standard screw fittings may change slightly during the life of the catalogue as a result of optimisation processes.

Další údaje na dotaz.

Popis

For air, water, steam, oil, etc.

Výrobek

Označení	Závit	L1 (mm)	SW
K- 07 40 15 16	M 5	11,0	8 mm
K- 07 40 15 17	G 1/8	15,0	14 mm
K- 07 40 15 18	G 1/4	22,0	17 mm
K- 07 40 15 19	G 3/8	23,0	22 mm
K- 07 40 15 20	G 1/2	28,0	26 mm
K- 07 40 15 21	G 3/4	32,0	32 mm