

K-DRV AG STECK SCHL GEW

Unidirectional flow control valves with conical male thread and plug connection, straight type, air restriction from tube to port

HANSA FLEX

Vlastnosti

| | |
|-------------------|--|
| Pracovní tlak | Max. 15 bar, coarse vacuum |
| Oblast použití | Air, vacuum |
| doporučené hadice | PU or PA (nylon) |
| Média | Compressed air and all gases or liquids that are compatible with the materials |
| Teplotní rozsah | -20 °C to +80 °C |
| Těsnicí plocha | Parallel version: O-ring in housing, Conical version: thread coating |
| Materiál | Plastic, Nickel plated brass |
| Přítlačný kroužek | Plastic |

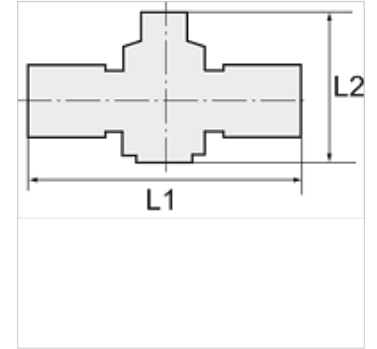

Upozornění

Další údaje na dotaz.

Popis

Push-in fittings series manufactured in plastic and nickel-plated brass. All parts are suitable for use with hoses, tubes or pipes made of plastic and copper.

Výrobek

| Označení | Závit | pro vnější Ø hadice | L1 (mm) | L2 min. (mm) | L2 max. (mm) | SW |
|----------------|-------|---------------------|---------|--------------|--------------|-------|
| K- 07 40 06 87 | R 1/8 | 4 mm | 45,9 | 26,9 | 29,0 | 10 mm |
| K- 07 40 06 88 | R 1/8 | 6 mm | 53,6 | 37,8 | 43,0 | 12 mm |
| K- 07 40 06 89 | R 1/8 | 8 mm | 58,4 | 41,5 | 47,2 | 14 mm |
| K- 07 40 06 85 | R 1/4 | 6 mm | 56,2 | 38,0 | 43,6 | 14 mm |
| K- 07 40 06 86 | R 1/4 | 8 mm | 60,6 | 41,1 | 47,1 | 14 mm |
| K- 07 40 06 83 | R 1/4 | 10 mm | 71,4 | 47,6 | 55,2 | 17 mm |
| K- 07 40 06 84 | R 1/4 | 12 mm | 82,3 | 51,8 | 55,6 | 21 mm |
| K- 07 40 06 92 | R 3/8 | 8 mm | 62,1 | 41,9 | 47,2 | 17 mm |
| K- 07 40 06 90 | R 3/8 | 10 mm | 71,8 | 48,3 | 54,9 | 17 mm |
| K- 07 40 06 91 | R 3/8 | 12 mm | 83,0 | 51,2 | 55,9 | 21 mm |
| K- 07 40 06 81 | R 1/2 | 10 mm | 75,4 | 48,0 | 54,6 | 21 mm |
| K- 07 40 06 82 | R 1/2 | 12 mm | 86,2 | 52,0 | 56,6 | 21 mm |