

# K-SV POM

## Bulkhead connectors

### Vlastnosti

<b>Pracovní tlak</b>	0 - 16 bar (4 - 8 mm); 0 - 10 bar (10 - 28 mm)
<b>Provozní teplota</b>	-20 °C to +70 °C in air; +1 °C to +70 °C in water
<b>Materiál</b>	Acetalpolymerisat (POM)
<b>Těsnicí materiál</b>	Nitrilkaučuk

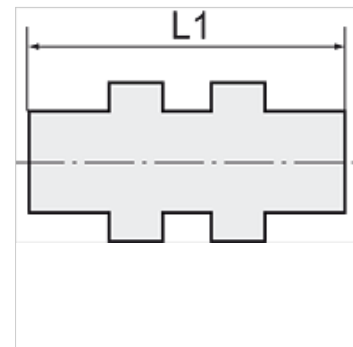
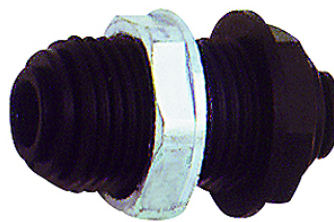

### Upozornění

Další údaje na dotaz.

### Popis

Lightweight, push-in fittings distinguished by high strength, toughness, resistance to abrasion and impact resistance - ideal for a wide range of applications. Plastic and metal tubes are connected together quickly and easily. Suitable for compressed air or liquids, with good resistance to a large number of chemicals.

### Výrobek

Označení	Závit	pro vnější Ø hadice	L1 (mm)	SW
K- 07 40 28 77	G 3/8	6 mm	36,5	19 mm
K- 07 40 28 76	G 1/2	8 mm	42,0	22 mm