

K-L-MEHRFACHVERT 2 DR AGR OR CLICK

Multiple union elbows with inner hex, 2 outlets, swivel type, parallel male thread with O-ring

HANSA FLEX

Vlastnosti

Pracovní tlak	Max. 16 bar
Provozní teplota	-20 °C to +80 °C
Materiál	poniklovaná mosaz
Přítlačný kroužek	Hostaform
O-kroužek	NBR
Rozpínací kroužek	Stainless steel

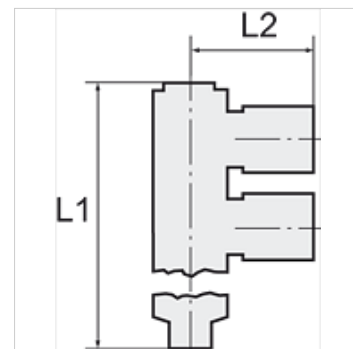

Upozornění

Další údaje na dotaz.

Popis

The advanced version of our highly successful push-in fittings series manufactured in nickel-plated brass. Advantages of this new, optimised series: Much easier connection and disconnection of the hose, even with repeated mounting, can also be used for non-calibrated hoses, suitable for vacuum operation.

Výrobek

Označení	Závit	pro vnější Ø hadice	L1 (mm)	L2 (mm)	SW
K- 07 40 26 50	M 5	4 mm	30,3	20,2	2 mm
K- 07 40 26 51	M 5	6 mm	30,3	23,5	2 mm
K- 07 40 26 55	G 1/8	4 mm	40,9	20,2	3 mm
K- 07 40 47 28	G 1/8	5 mm	42,0	25,0	5 mm
K- 07 40 26 56	G 1/8	6 mm	40,9	23,5	3 mm
K- 07 40 26 57	G 1/8	8 mm	40,9	24,8	3 mm
K- 07 40 26 53	G 1/4	6 mm	47,0	23,0	4 mm
K- 07 40 26 54	G 1/4	8 mm	47,0	26,5	4 mm
K- 07 40 26 52	G 1/4	10 mm	47,0	31,4	4 mm