

# K-SCHALLDAE STECKNIPPEL

Silencers with push-in plug (pressure max. 10 bar)

**HANSA FLEX**

## Vlastnosti

<b>Pracovní tlak</b>	Max. 15 bar, coarse vacuum
<b>Oblast použití</b>	Air, vacuum
<b>doporučené hadice</b>	PU or PA (nylon)
<b>Média</b>	Compressed air and all gases or liquids that are compatible with the materials
<b>Teplotní rozsah</b>	-20 °C to +80 °C
<b>Těsnicí plocha</b>	Parallel version: O-ring in housing, Conical version: thread coating
<b>Materiál</b>	Plastic, Nickel plated brass
<b>Přítlačný kroužek</b>	Plastic

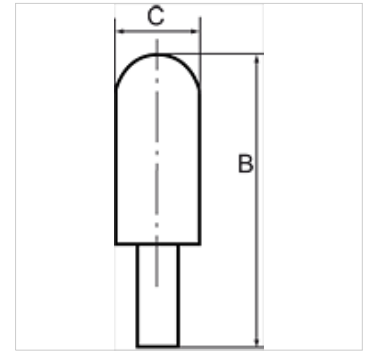

## Upozornění

Další údaje na dotaz.

## Popis

Push-in fittings series manufactured in plastic and nickel-plated brass. All parts are suitable for use with hoses, tubes or pipes made of plastic and copper.

## Výrobek

Označení	pro vnější Ø hadice	L1 (mm)
K- 07 40 46 91	6 mm	46,5
K- 07 40 46 92	8 mm	45,0
K- 07 40 46 93	10 mm	58,0
K- 07 40 46 94	12 mm	81,5