

Eigenschaften

Anschluss 1	NPT-Außengewinde
Dichtform 1	gewindedichtend
Anschluss 2	metrisches Außengewinde zylindrisch
Dichtform 2	24° Innenkonus
Bauart	Einschraub-Verschraubung
Bauform	Winkel 90°
Norm	DIN 2353 ISO 8434-1
Lieferumfang	Stutzen (ohne Überwurfmutter und Schneidring)
Werkstoff	Stahl
Oberfläche	galvanisch beschichtet

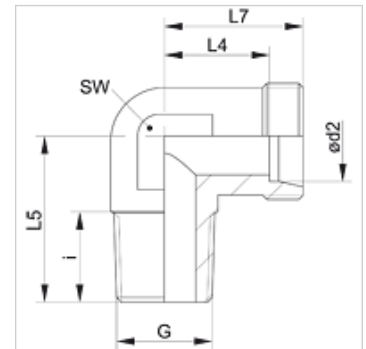

Hinweis

Hinweise zur Montage, Einbau, Druckbelastung und zulässige Betriebstemperaturen entnehmen Sie bitte den technischen Informationen für Rohrverschraubungen.

Artikel

Bezeichnung	Baureihe	Betriebsdruck	Rohr-Außen Ø (mm)	G	i (mm)	L4 (mm)	L5 (mm)	L7 (mm)	SW (mm)
XWN 04 LL	LL	PN 100	4	1/8" -27 NPT	8,0	11,0	17	15,0	9
XWN 05 LL	LL	PN 100	5	1/8" -27 NPT	8,0	11,0	17	15,0	9
XWN 06 LL	LL	PN 100	6	1/8" -27 NPT	8,0	9,5	17	15,0	9
XWN 08 LL	LL	PN 100	8	1/8" -27 NPT	10,0	11,5	20	17,0	12
XWN NW 04 HL	L	PN 315	6	1/8" -27 NPT	10,0	12,0	20	19,0	12
XWN NW 04 HL 1/4	L	PN 315	6	1/4" -18 NPT	12,0	14,0	26	21,0	12
XWN NW 04 HL 1/2	L	PN 315	6	1/2" -14 NPT	17,0	23,0	34	30,0	19
XWN NW 06 HL	L	PN 315	8	1/4" -18 NPT	12,0	14,0	26	21,0	12
XWN NW 06 HL 3/8	L	PN 315	8	3/8" -18 NPT	15,2	11,5	20	18,5	12
XWN NW 06 HL 1/2	L	PN 315	8	1/2" -14 NPT	17,5	15,0	26	22,0	12
XWN NW 08 HL	L	PN 315	10	1/4" -18 NPT	14,0	15,0	27	22,0	14
XWN NW 08 HL 3/8	L	PN 315	10	3/8" -18 NPT	15,2	15,0	27	22,0	14
XWN NW 10 HL	L	PN 315	12	3/8" -18 NPT	12,5	17,0	28	24,0	17
XWN NW 10 HL 1/4	L	PN 315	12	1/4" -18 NPT	14,0	17,0	28	24,0	17
XWN NW 10 HL 1/2	L	PN 315	12	1/2" -14 NPT	19,0	23,0	34	30,0	19
XWN NW 13 HL	L	PN 315	15	1/2" -14 NPT	18,5	21,0	34	28,0	19
XWN NW 13 HL 3/8	L	PN 315	15	3/8" -18 NPT	13,0	21,0	34	28,0	19
XWN NW 16 HL	L	PN 315	18	1/2" -14 NPT	20,0	23,5	36	31,0	24
XWN NW 16 HL 3/4	L	PN 315	18	3/4" -14 NPT	18,5	23,5	40	31,0	24
XWN NW 20 HL	L	PN 160	22	3/4" -14 NPT	18,5	27,5	42	35,0	27
XWN NW 25 HL	L	PN 160	28	1" -11,5 NPT	24,0	30,5	48	38,0	36
XWN NW 32 HL	L	PN 160	35	1.1/4" -11,5 NPT	25,5	34,5	54	45,0	41
XWN NW 40 HL	L	PN 160	42	1.1/2" -11,5 NPT	26,0	40,0	61	51,0	50
XWN NW 03 HS	S	PN 630	6	1/4" -18 NPT	12,0	16,0	26	23,0	12
XWN NW 04 HS	S	PN 630	8	1/4" -18 NPT	15,0	17,0	27	24,0	14
XWN NW 06 HS	S	PN 630	10	3/8" -18 NPT	12,0	17,5	28	25,0	17
XWN NW 08 HS	S	PN 630	12	3/8" -18 NPT	12,5	21,5	28	29,0	17
XWN NW 10 HS	S	PN 630	14	1/2" -14 NPT	18,0	22,0	34	30,0	19
XWN NW 13 HS	S	PN 400	16	1/2" -14 NPT	19,0	24,5	36	33,0	24
XWN NW 13 HS 3/4	S	PN 400	16	3/4" -14 NPT	20,0	24,5	40	33,0	24
XWN NW 16 HS	S	PN 400	20	3/4" -14 NPT	20,0	26,6	42	37,0	27
XWN NW 20 HS	S	PN 400	25	1" -11,5 NPT	24,0	30,0	48	42,0	36
XWN NW 25 HS	S	PN 400	30	1.1/4" -11,5 NPT	25,5	35,5	54	49,0	41
XWN NW 32 HS	S	PN 315	38	1.1/2" -11,5 NPT	26,0	41,0	61	57,0	50

Baureihe: LL = Sehr Leicht L = Leicht S = Schwer – PN = Nenndruck PB = max. Betriebsdruck – ød2 = Rohraußendurchmesser

Produktvarianten

XWN VA	Einschraub-Verschraubung, Winkel 90°, Edelstahl
WN	Einschraub-Verschraubung, Winkel 90°, Stahl