

Properties

Connection 1	metric nut thread
Sealing form 1	Pipe socket, pre-assembled
Connection 2 + 3	metric cylindrical outer thread
Sealing form 2 + 3	24° inner cone
Design	Adjustable direction fitting
Construction	L shaped
Standard	DIN 2353 ISO 8434-1
Scope of supply	Socket with union nut and cutting ring
Material	Steel
Surface	electro galvanised

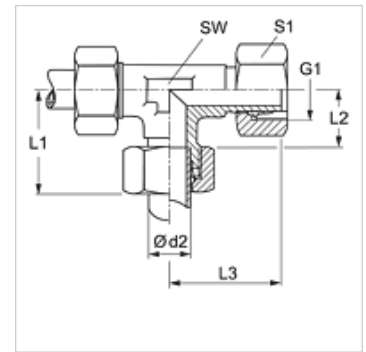

Note

Information about fitting, installation, pressure loads and permissible operating temperatures can be found in the technical information for pipe fittings.

Item

Identification	Series	Operating pressure	Ø d2 (mm)	G1	L1 (mm)	L2 (mm)	L3 (mm)	AF (mm)	S1
VEL 16 LL	LL	PN 100	16	M 22 x 1.5	36	21,0	21,0	19	27
VEL NW 04 HL	L	PN 315	6	M 12 x 1.5	27	12,0	26,0	12	14
VEL NW 06 HL	L	PN 315	8	M 14 x 1.5	29	14,0	27,0	12	17
VEL NW 08 HL	L	PN 315	10	M 16 x 1.5	30	15,0	28,5	14	19
VEL NW 10 HL	L	PN 315	12	M 18 x 1.5	32	17,0	29,0	17	22
VEL NW 13 HL	L	PN 315	15	M 22 x 1.5	36	21,0	32,0	19	27
VEL NW 16 HL	L	PN 315	18	M 26 x 1.5	40	23,5	35,0	24	32
VEL NW 20 HL	L	PN 160	22	M 30 x 2	44	27,5	38,0	27	36
VEL NW 25 HL	L	PN 160	28	M 36 x 2	47	30,5	41,5	36	41
VEL NW 32 HL	L	PN 160	35	M 45 x 2	56	34,5	51,0	41	50
VEL NW 40 HL	L	PN 160	42	M 52 x 2	63	40,0	56,0	50	60
VEL NW 03 HS	S	PN 630	6	M 14 x 1.5	31	16,0	27,0	12	17
VEL NW 04 HS	S	PN 630	8	M 16 x 1.5	32	17,0	27,0	14	19
VEL NW 06 HS	S	PN 630	10	M 18 x 1.5	34	17,5	29,5	17	22
VEL NW 08 HS	S	PN 630	12	M 20 x 1.5	38	21,5	30,5	17	24
VEL NW 10 HS	S	PN 630	14	M 22 x 1.5	40	22,0	34,5	19	27
VEL NW 13 HS	S	PN 400	16	M 24 x 1.5	43	24,5	36,0	24	30
VEL NW 16 HS	S	PN 400	20	M 30 x 2	48	26,5	44,0	27	36
VEL NW 20 HS	S	PN 400	25	M 36 x 2	54	30,0	49,5	36	46
VEL NW 25 HS	S	PN 400	30	M 42 x 2	62	35,5	55,0	41	50
VEL NW 32 HS	S	PN 315	38	M 52 x 2	72	41,0	63,0	50	60

Series: LL = Very light L = Light S = Heavy – PN = Nominal pressure PB = Max. operating pressure – Ø d2 = External pipe diameter

Product versions

VEL MG	Fitting, L shaped, Brass
VEL VA	Fitting, L shaped, Stainless steel
XVEL	Fitting, L shaped, Steel