

Properties

Connection 1 - 4	metric cylindrical outer thread
Sealing form 1 - 4	24° inner cone
Design	Fitting
Construction	K shaped
Standard	DIN 2353 ISO 8434-1
Scope of supply	Socket (without union nut and cutting ring)
Material	Steel
Surface	electro galvanised

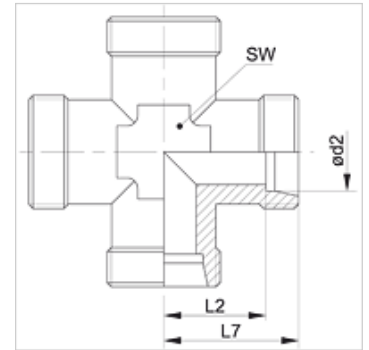

Note

Information about fitting, installation, pressure loads and permissible operating temperatures can be found in the technical information for pipe fittings.

Item

Identification	Series	Operating pressure	Ø d2 (mm)	L2 (mm)	L7 (mm)	AF (mm)
XK 04 LL	LL	PN 100	4	11,0	15,0	9
XK 05 LL	LL	PN 100	5	9,5	15,0	9
XK 06 LL	LL	PN 100	6	9,5	15,0	9
XK 08 LL	LL	PN 100	8	11,5	17,0	12
XK NW 04 HL	L	PN 315	6	12,0	19,0	12
XK NW 06 HL	L	PN 315	8	14,0	21,0	12
XK NW 08 HL	L	PN 315	10	15,0	22,0	14
XK NW 10 HL	L	PN 315	12	17,0	24,0	17
XK NW 13 HL	L	PN 315	15	21,0	28,0	19
XK NW 16 HL	L	PN 315	18	23,5	31,0	24
XK NW 20 HL	L	PN 160	22	27,5	35,0	27
XK NW 25 HL	L	PN 160	28	30,5	38,0	36
XK NW 32 HL	L	PN 160	35	34,5	45,0	41
XK NW 40 HL	L	PN 160	42	40,0	51,0	50
XK NW 03 HS	S	PN 630	6	16,0	23,0	12
XK NW 04 HS	S	PN 630	8	17,0	24,0	14
XK NW 06 HS	S	PN 630	10	17,5	25,0	17
XK NW 08 HS	S	PN 630	12	21,5	29,0	17
XK NW 10 HS	S	PN 630	14	22,0	30,0	19
XK NW 13 HS	S	PN 400	16	24,5	33,0	24
XK NW 16 HS	S	PN 400	20	26,5	37,0	27
XK NW 20 HS	S	PN 400	25	30,0	42,0	36
XK NW 25 HS	S	PN 400	30	35,5	49,0	41
XK NW 32 HS	S	PN 315	38	41,0	57,0	50

Series: LL = Very light L = Light S = Heavy - PN = Nominal pressure PB = Max. operating pressure - Ø d2 = External pipe diameter

Product versions

XK VA	Fitting, cross shaped, Stainless steel
K	Fitting, cross shaped, Steel