

### Properties

<b>Connection 1</b>	metric cylindrical outer thread
<b>Sealing form 1</b>	Shape B
<b>Connection 2 + 3</b>	metric cylindrical outer thread
<b>Sealing form 2 + 3</b>	24° inner cone
<b>Design</b>	Screw-in fitting
<b>Construction</b>	L shaped
<b>Standard</b>	DIN 2353
<b>Scope of supply</b>	Socket (without union nut and cutting ring)
<b>Material</b>	Steel
<b>Surface</b>	electro galvanised

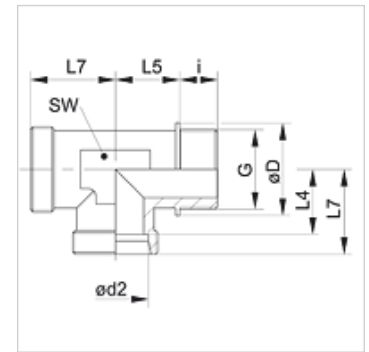

### Note

Information about fitting, installation, pressure loads and permissible operating temperatures can be found in the technical information for pipe fittings.

### Item

Identification	Series	Operating pressure	Ø d2 (mm)	G	Ø D (mm)	i (mm)	L4 (mm)	L5 (mm)	L7 (mm)	AF (mm)
XLM NW 20 HL	L	PN 160	22	M 26 x 1.5	31,0	16	27,5	26	35	27
XLM NW 25 HL	L	PN 160	28	M 33 x 2	39,0	18	30,5	30	38	36
XLM NW 32 HL	L	PN 160	35	M 42 x 2	49,0	20	34,5	34	45	41
XLM NW 40 HL	L	PN 160	42	M 48 x 2	55,0	22	40,0	39	51	50
XLM NW 16 HS	S	PN 400	20	M 27 x 2	32,0	16	26,5	26	37	27
XLM NW 20 HS	S	PN 400	25	M 33 x 2	39,0	18	30,0	30	42	36
XLM NW 25 HS	S	PN 250	30	M 42 x 2	49,0	20	35,5	34	49	41
XLM NW 32 HS	S	PN 250	38	M 48 x 2	55,0	22	41,0	39	57	50

Series: LL = Very light L = Light S = Heavy – PN = Nominal pressure PB = Max. operating pressure – Ø d2 = External pipe diameter

### Product versions

<b>XLM VA</b>	Screw-in fitting, L shaped, Stainless steel
<b>LM</b>	Screw-in fitting, L shaped, Steel