

Properties

Connection 1	Pipe socket not pre-assembled
Sealing form 1	Cutting ring connection
Connection 2 + 3	metric cylindrical outer thread
Sealing form 2 + 3	24° inner cone
Design	Adjustable direction fitting
Construction	L shaped
Scope of supply	Socket (without union nut and cutting ring)
Material	Steel
Surface	electro galvanised

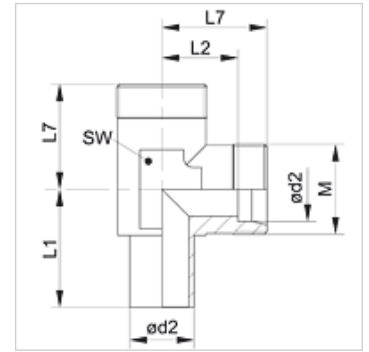

Note

Information about fitting, installation, pressure loads and permissible operating temperatures can be found in the technical information for pipe fittings.

Item

Identification	Series	Operating pressure	Ø d2 (mm)	G1	L1 (mm)	L2 (mm)	L7 (mm)	AF (mm)
XNEL NW 04 HL	L	PN 315	6	M 12 x 1.5	26,0	12,0	19	12
XNEL NW 06 HL	L	PN 315	8	M 14 x 1.5	27,5	14,0	21	12
XNEL NW 08 HL	L	PN 315	10	M 16 x 1.5	29,0	15,0	22	14
XNEL NW 10 HL	L	PN 315	12	M 18 x 1.5	29,5	17,0	24	17
XNEL NW 13 HL	L	PN 315	15	M 22 x 1.5	32,5	21,0	28	19
XNEL NW 16 HL	L	PN 315	18	M 26 x 1.5	35,5	23,5	31	24
XNEL NW 20 HL	L	PN 160	22	M 30 x 2	38,5	27,5	35	27
XNEL NW 25 HL	L	PN 160	28	M 36 x 2	41,5	30,5	38	36
XNEL NW 32 HL	L	PN 160	35	M 45 x 2	51,0	34,5	45	41
XNEL NW 40 HL	L	PN 160	42	M 52 x 2	56,0	40,0	51	50
XNEL NW 03 HS	S	PN 630	6	M 14 x 1.5	29,0	16,0	23	12
XNEL NW 04 HS	S	PN 630	8	M 16 x 1.5	27,5	17,0	24	14
XNEL NW 06 HS	S	PN 630	10	M 18 x 1.5	30,0	17,5	25	17
XNEL NW 08 HS	S	PN 630	12	M 20 x 1.5	31,0	21,5	29	17
XNEL NW 10 HS	S	PN 630	14	M 22 x 1.5	35,0	22,0	30	19
XNEL NW 13 HS	S	PN 400	16	M 24 x 1.5	36,5	24,5	33	24
XNEL NW 16 HS	S	PN 400	20	M 30 x 2	44,5	26,5	37	27
XNEL NW 20 HS	S	PN 400	25	M 36 x 2	50,0	30,0	42	36
XNEL NW 25 HS	S	PN 400	30	M 42 x 2	55,0	35,5	49	41
XNEL NW 32 HS	S	PN 315	38	M 52 x 2	63,0	41,0	57	50

Series: LL = Very light L = Light S = Heavy - PN = Nominal pressure PB = Max. operating pressure - Ø d2 = External pipe diameter

Product versions

XNEL VA	Fitting, L shaped, Stainless steel
NEL	Fitting, L shaped, Steel

Additional elements

VOM	Pre-assembly sockets
------------	----------------------