

Properties

Connection 1	metric nut thread
Sealing form 1	Pipe socket, pre-assembled
Connection 2 + 3	metric cylindrical outer thread
Sealing form 2 + 3	24° inner cone
Design	Adjustable direction fitting
Construction	L shaped
Standard	DIN 2353 ISO 8434-1
Scope of supply	Socket (without union nut and cutting ring) pre-assembled
Material	Steel
Surface	electro galvanised

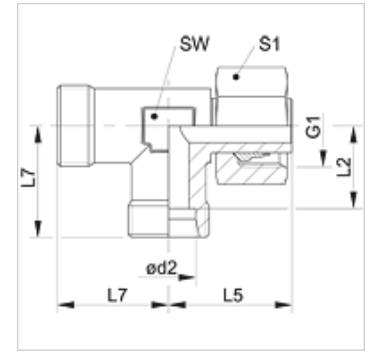

Note

Information about fitting, installation, pressure loads and permissible operating temperatures can be found in the technical information for pipe fittings.

Item

Identification	Series	Operating pressure	Ø d2 (mm)	G1	L2 (mm)	L5 (mm)	L7 (mm)	AF (mm)	S1
XVEL NW 04 HL	L	PN 315	6	M 12 x 1.5	12,0	26,0	19	12	14
XVEL NW 06 HL	L	PN 315	8	M 14 x 1.5	14,0	27,5	21	12	17
XVEL NW 08 HL	L	PN 315	10	M 16 x 1.5	15,0	29,0	22	14	19
XVEL NW 10 HL	L	PN 315	12	M 18 x 1.5	17,0	29,5	24	17	22
XVEL NW 13 HL	L	PN 315	15	M 22 x 1.5	21,0	32,5	28	19	27
XVEL NW 16 HL	L	PN 315	18	M 26 x 1.5	23,5	35,5	31	24	32
XVEL NW 20 HL	L	PN 160	22	M 30 x 2	27,5	38,5	35	27	36
XVEL NW 25 HL	L	PN 160	28	M 36 x 2	30,5	41,5	38	36	41
XVEL NW 32 HL	L	PN 160	35	M 45 x 2	34,5	51,0	45	41	50
XVEL NW 40 HL	L	PN 160	42	M 52 x 2	40,0	56,0	51	50	60
XVEL NW 03 HS	S	PN 630	6	M 14 x 1.5	16,0	27,0	23	12	17
XVEL NW 04 HS	S	PN 630	8	M 16 x 1.5	17,0	27,5	24	14	19
XVEL NW 06 HS	S	PN 630	10	M 18 x 1.5	17,5	30,0	25	17	22
XVEL NW 08 HS	S	PN 630	12	M 20 x 1.5	21,5	31,0	29	17	24
XVEL NW 10 HS	S	PN 630	14	M 22 x 1.5	22,0	35,0	30	19	27
XVEL NW 13 HS	S	PN 400	16	M 24 x 1.5	24,5	36,5	33	24	30
XVEL NW 16 HS	S	PN 400	20	M 30 x 2	26,5	44,5	37	27	36
XVEL NW 20 HS	S	PN 400	25	M 36 x 2	30,0	50,0	42	36	46
XVEL NW 25 HS	S	PN 400	30	M 42 x 2	35,5	55,0	49	41	50
XVEL NW 32 HS	S	PN 315	38	M 52 x 2	41,0	63,0	57	50	60

Series: LL = Very light L = Light S = Heavy – PN = Nominal pressure PB = Max. operating pressure – Ø d2 = External pipe diameter

Product versions

XVEL VA	Fitting, L shaped, Stainless steel
VEL	Fitting, L shaped, Steel