

Properties

Connection 1	metric nut thread
Sealing form 1	24° outer cone with O-ring
Connection 2 + 3	metric cylindrical outer thread
Sealing form 2 + 3	24° inner cone
Design	Adjustable direction fitting
Construction	L shaped
Standard	ISO 8434-4
Scope of supply	Socket (without union nut and cutting ring)
Material	Steel
Surface	electro galvanised

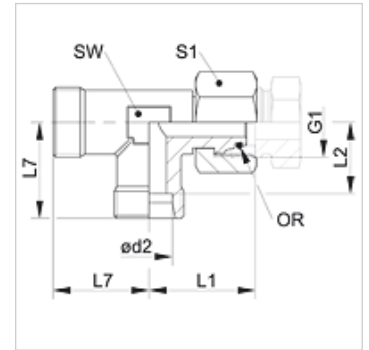

Note

Information about fitting, installation, pressure loads and permissible operating temperatures can be found in the technical information for pipe fittings.

Item

Identification	Series	Operating pressure	Ø d2 (mm)	G1	L1 (mm)	L2 (mm)	L7 (mm)	AF (mm)	S1	OR
XVELO NW 04 HL	L	PN 315	6	M 12 x 1.5	26,0	12,0	19	12	14	4.0 x 1.5
XVELO NW 06 HL	L	PN 315	8	M 14 x 1.5	26,5	14,0	21	12	17	6.0 x 1.5
XVELO NW 08 HL	L	PN 315	10	M 16 x 1.5	29,0	15,0	22	14	19	7.5 x 1.5
XVELO NW 10 HL	L	PN 315	12	M 18 x 1.5	29,5	17,0	24	17	22	9.0 x 1.5
XVELO NW 13 HL	L	PN 315	15	M 22 x 1.5	33,0	21,0	28	19	27	12.0 x 2.0
XVELO NW 16 HL	L	PN 315	18	M 26 x 1.5	35,5	23,5	31	24	32	15.0 x 2.0
XVELO NW 20 HL	L	PN 160	22	M 30 x 2	38,5	27,5	35	27	36	20.0 x 2.0
XVELO NW 25 HL	L	PN 160	28	M 36 x 2	43,0	30,5	38	36	41	26.0 x 2.0
XVELO NW 32 HL	L	PN 160	35	M 45 x 2	51,5	34,5	45	41	50	32.0 x 2.5
XVELO NW 40 HL	L	PN 160	42	M 52 x 2	56,0	40,0	51	50	60	38.0 x 2.5
XVELO NW 03 HS	S	PN 630	6	M 14 x 1.5	27,0	16,0	23	12	17	4.0 x 1.5
XVELO NW 04 HS	S	PN 630	8	M 16 x 1.5	27,5	17,0	24	14	19	6.0 x 1.5
XVELO NW 06 HS	S	PN 630	10	M 18 x 1.5	30,5	17,5	25	17	22	7.5 x 1.5
XVELO NW 08 HS	S	PN 630	12	M 20 x 1.5	31,0	21,5	29	17	24	9.0 x 1.5
XVELO NW 10 HS	S	PN 630	14	M 22 x 1.5	35,0	22,0	30	19	27	10.0 x 2.0
XVELO NW 13 HS	S	PN 400	16	M 24 x 1.5	37,5	24,5	33	24	30	12.0 x 2.0
XVELO NW 16 HS	S	PN 400	20	M 30 x 2	44,5	26,5	37	27	36	16.3 x 2.4
XVELO NW 20 HS	S	PN 400	25	M 36 x 2	50,5	30,0	42	36	46	
XVELO NW 25 HS	S	PN 400	30	M 42 x 2	55,0	35,5	49	41	50	25.3 x 2.4
XVELO NW 32 HS	S	PN 315	38	M 52 x 2	62,4	41,0	57	50	60	33.3 x 2.4

Series: LL = Very light L = Light S = Heavy – PN = Nominal pressure PB = Max. operating pressure – Ø = External pipe diameter

Product versions

XVELO VA	Fitting, L shaped, Stainless steel
VELO	Fitting, L shaped, Steel