

Properties

Connection 1	metric nut thread
Sealing form 1	24° outer cone with O-ring
Connection 2 + 3	metric cylindrical outer thread
Sealing form 2 + 3	24° inner cone
Design	Adjustable direction fitting
Construction	L shaped
Standard	DIN 3944
Scope of supply	Socket (without union nut and cutting ring)
Material	Stainless steel

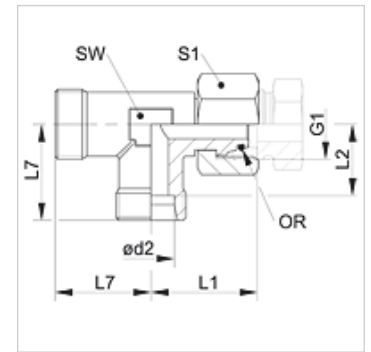

Note

Information about fitting, installation, pressure loads and permissible operating temperatures can be found in the technical information for pipe fittings.

Ordering information

Seals of NBR
FPM (Viton) on request

Item

Identification	Series	Operating pressure	Ø d2 (mm)	G1	L1 (mm)	L2 (mm)	L7 (mm)	AF (mm)	S1	OR
XVELO NW 04 HL VA	L	PN 315	6	M 12 x 1.5	26,0	12,0	19	12	14	4.0 x 1.5
XVELO NW 06 HL VA	L	PN 315	8	M 14 x 1.5	27,5	14,0	21	12	17	6.0 x 1.5
XVELO NW 08 HL VA	L	PN 315	10	M 16 x 1.5	29,0	15,0	22	14	19	7.5 x 1.5
XVELO NW 10 HL VA	L	PN 315	12	M 18 x 1.5	29,5	17,0	24	17	22	9.0 x 1.5
XVELO NW 13 HL VA	L	PN 315	15	M 22 x 1.5	32,5	21,0	28	19	27	12.0 x 2.0
XVELO NW 16 HL VA	L	PN 315	18	M 26 x 1.5	35,5	23,5	31	24	32	15.0 x 2.0
XVELO NW 20 HL VA	L	PN 160	22	M 30 x 2	38,5	27,5	35	27	36	20.0 x 2.0
XVELO NW 25 HL VA	L	PN 160	28	M 36 x 2	41,5	30,5	38	36	41	26.0 x 2.0
XVELO NW 32 HL VA	L	PN 160	35	M 45 x 2	51,0	34,5	45	41	50	32.0 x 2.5
XVELO NW 40 HL VA	L	PN 160	42	M 52 x 2	56,0	40,0	51	50	60	38.0 x 2.5
XVELO NW 03 HS VA	S	PN 630	6	M 14 x 1.5	27,0	16,0	23	12	17	4.0 x 1.5
XVELO NW 04 HS VA	S	PN 630	8	M 16 x 1.5	27,5	17,0	24	14	19	6.0 x 1.5
XVELO NW 06 HS VA	S	PN 630	10	M 18 x 1.5	30,0	17,5	25	17	22	7.5 x 1.5
XVELO NW 08 HS VA	S	PN 630	12	M 20 x 1.5	31,0	21,5	29	17	24	9.0 x 1.5
XVELO NW 10 HS VA	S	PN 630	14	M 22 x 1.5	35,0	22,0	30	19	27	10.0 x 2.0
XVELO NW 13 HS VA	S	PN 400	16	M 24 x 1.5	36,5	24,5	33	24	30	12.0 x 2.0
XVELO NW 16 HS VA	S	PN 400	20	M 30 x 2	44,5	26,5	37	27	36	16.3 x 2.4
XVELO NW 20 HS VA	S	PN 400	25	M 36 x 2	50,0	30,0	42	36	46	20.3 x 2.4
XVELO NW 25 HS VA	S	PN 400	30	M 42 x 2	55,0	35,5	49	41	50	25.3 x 2.4
XVELO NW 32 HS VA	S	PN 315	38	M 52 x 2	63,0	41,0	57	50	60	33.3 x 2.4

Series: LL = Very light L = Light S = Heavy – PN = Nominal pressure PB = Max. operating pressure – Ø = External pipe diameter

Product versions

XVELO	Fitting, L shaped, Steel
VELO VA	Fitting, L shaped, Stainless steel