

Properties

Connection 1	BSP cylindrical internal threads
Sealing form 1	Shape A
Connection 2	metric cylindrical outer thread
Sealing form 2	24° inner cone
Design	Screw-on fitting
Construction	straight
Standard	DIN 2353 ISO 8434-1
Scope of supply	Socket with union nut and cutting ring
Material	Brass

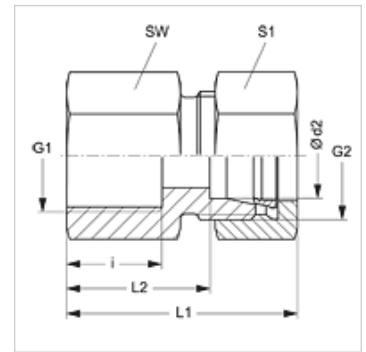

Note

Information about fitting, installation, pressure loads and permissible operating temperatures can be found in the technical information for pipe fittings.

Item

Identification	Series	Operating pressure	Ø d2 (mm)	G1	G2	i (mm)	L1 (mm)	L2 (mm)	AF (mm)	S1
GAR NW 04 HL MG	L	PN 200	6	G 1/8" -28	M 12 x 1.5	12,0	34,0	19,0	14	14
GAR NW 06 HL MG	L	PN 200	8	G 1/4" -19	M 14 x 1.5	17,0	39,0	24,0	19	17
GAR NW 06 HL 1/2 MG	L	PN 200	8	G 1/2" -14	M 14 x 1.5	20,0	44,0	29,0	27	17
GAR NW 08 HL MG	L	PN 200	10	G 1/4" -19	M 16 x 1.5	17,0	40,0	25,0	19	19
GAR NW 10 HL MG	L	PN 200	12	G 3/8" -19	M 18 x 1.5	17,0	41,0	26,0	22	22
GAR NW 13 HL MG	L	PN 200	15	G 1/2" -14	M 22 x 1.5	20,0	45,0	30,0	27	27
GAR NW 16 HL MG	L	PN 200	18	G 1/2" -14	M 26 x 1.5	20,0	46,0	29,5	27	32
GAR NW 20 HL MG	L	PN 100	22	G 3/4" -14	M 30 x 2	22,0	51,0	34,5	32	36
GAR NW 04 HS MG	S	PN 250	8	G 1/4" -19	M 16 x 1.5	17,0	41,0	26,0	19	19
GAR NW 06 HS MG	S	PN 250	10	G 3/8" -19	M 18 x 1.5	17,0	42,0	26,5	24	22

Series: LL = Very light L = Light S = Heavy – PN = Nominal pressure PB = Max. operating pressure – Ø d2 = External pipe diameter

Product versions

GAR	Screw-on fitting, Steel
GAR VA	Screw-on fitting, Stainless steel