

## Properties

|                        |  |
|------------------------|--|
| <b>Connection 1</b>    | BSP cylindrical internal threads       |
| <b>Sealing form 1</b>  | Shape A                                |
| <b>Connection 2</b>    | metric cylindrical outer thread        |
| <b>Sealing form 2</b>  | 24° inner cone                         |
| <b>Design</b>          | Screw-on fitting                       |
| <b>Construction</b>    | straight                               |
| <b>Standard</b>        | DIN 2353<br>ISO 8434-1                 |
| <b>Scope of supply</b> | Socket with union nut and cutting ring |
| <b>Material</b>        | Stainless steel                        |

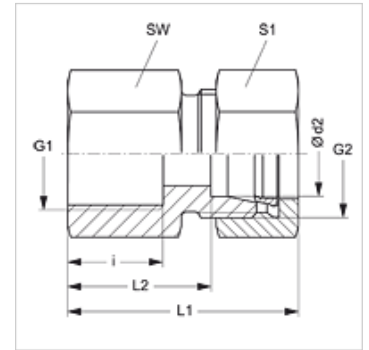

## Item

| Identification      | Series | Operating pressure | Ø d2<br>(mm) | G1           | G2         | i<br>(mm) | L1<br>(mm) | L2<br>(mm) | AF<br>(mm) | S1 |
|---------------------|--------|--------------------|--------------|--------------|------------|-----------|------------|------------|------------|----|
| GAR NW 04 HL VA     | L      | PN 315             | 6            | G 1/8" -28   | M 12 x 1.5 | 12,0      | 34,0       | 19,0       | 14         | 14 |
| GAR NW 04 HL 1/4 VA | L      | PN 315             | 6            | G 1/4" -19   | M 12 x 1.5 | 12,0      | 34,0       | 19,0       | 14         | 14 |
| GAR NW 04 HL 3/8 VA | L      | PN 315             | 6            | G 3/8" -19   | M 12 x 1.5 | 12,0      | 36,0       | 21,0       | 22         | 14 |
| GAR NW 04 HL 1/2 VA | L      | PN 315             | 6            | G 1/2" -14   | M 12 x 1.5 | 20,0      | 46,0       | 31,0       | 27         | 14 |
| GAR NW 06 HL VA     | L      | PN 315             | 8            | G 1/4" -19   | M 14 x 1.5 | 17,0      | 39,0       | 24,0       | 19         | 17 |
| GAR NW 06 HL 3/8 VA | L      | PN 315             | 8            | G 3/8" -19   | M 14 x 1.5 | 17,0      | 36,0       | 21,0       | 22         | 17 |
| GAR NW 06 HL 1/2 VA | L      | PN 315             | 8            | G 1/2" -14   | M 14 x 1.5 | 20,0      | 44,0       | 29,0       | 27         | 17 |
| GAR NW 08 HL VA     | L      | PN 315             | 10           | G 1/4" -19   | M 16 x 1.5 | 17,0      | 40,0       | 25,0       | 19         | 19 |
| GAR NW 08 HL 3/8 VA | L      | PN 315             | 10           | G 3/8" -19   | M 16 x 1.5 | 17,0      | 40,0       | 26,0       | 22         | 19 |
| GAR NW 08 HL 1/2 VA | L      | PN 315             | 10           | G 1/2" -14   | M 16 x 1.5 | 20,0      | 45,0       | 30,0       | 27         | 19 |
| GAR NW 10 HL 1/4 VA | L      | PN 315             | 12           | G 1/4" -19   | M 18 x 1.5 | 17,0      | 41,0       | 25,0       | 19         | 22 |
| GAR NW 10 HL VA     | L      | PN 315             | 12           | G 3/8" -19   | M 18 x 1.5 | 17,0      | 41,0       | 26,0       | 22         | 22 |
| GAR NW 10 HL 1/2 VA | L      | PN 315             | 12           | G 1/2" -14   | M 18 x 1.5 | 20,0      | 44,0       | 30,0       | 27         | 22 |
| GAR NW 13 HL 3/8 VA | L      | PN 315             | 15           | G 3/8" -19   | M 22 x 1.5 | 17,0      | 46,0       | 27,0       | 24         | 27 |
| GAR NW 13 HL VA     | L      | PN 315             | 15           | G 1/2" -14   | M 22 x 1.5 | 20,0      | 45,0       | 30,0       | 27         | 27 |
| GAR NW 16 HL 3/8 VA | L      | PN 315             | 18           | G 3/8" -19   | M 26 x 1.5 | 17,5      | 47,0       | 26,5       | 27         | 32 |
| GAR NW 16 HL VA     | L      | PN 315             | 18           | G 1/2" -14   | M 26 x 1.5 | 20,0      | 46,0       | 29,5       | 27         | 32 |
| GAR NW 20 HL 1/2 VA | L      | PN 160             | 22           | G 1/2" -14   | M 30 x 2   | 20,0      | 55,0       | 33,5       | 32         | 36 |
| GAR NW 20 HL VA     | L      | PN 160             | 22           | G 3/4" -14   | M 30 x 2   | 22,0      | 51,0       | 34,5       | 32         | 36 |
| GAR NW 25 HL VA     | L      | PN 160             | 28           | G 1" -11     | M 36 x 2   | 24,5      | 53,5       | 37,0       | 41         | 41 |
| GAR NW 32 HL VA     | L      | PN 160             | 35           | G 1.1/4" -11 | M 45 x 2   | 26,5      | 60,5       | 39,0       | 50         | 50 |
| GAR NW 40 HL VA     | L      | PN 160             | 42           | G 1.1/2" -11 | M 52 x 2   | 28,5      | 63,5       | 40,5       | 55         | 60 |
|                     |        |                    |              |              |            |           |            |            |            |    |
| GAR NW 03 HS 1/8 VA | S      | PN 400             | 6            | G 1/8" -28   | M 14 x 1.5 | 12,0      | 34,0       | 19,0       | 14         | 14 |
| GAR NW 03 HS VA     | S      | PN 400             | 6            | G 1/4" -19   | M 14 x 1.5 | 17,0      | 41,0       | 26,0       | 19         | 17 |
| GAR NW 04 HS VA     | S      | PN 400             | 8            | G 1/4" -19   | M 16 x 1.5 | 17,0      | 41,0       | 26,0       | 19         | 19 |
| GAR NW 06 HS VA     | S      | PN 400             | 10           | G 3/8" -19   | M 18 x 1.5 | 17,0      | 42,0       | 26,5       | 24         | 22 |
| GAR NW 06 HS 1/2 VA | S      | PN 400             | 10           | G 1/2" -14   | M 18 x 1.5 | 20,0      | 49,5       | 30,5       | 27         | 22 |
| GAR NW 08 HS 1/4 VA | S      | PN 400             | 12           | G 1/4" -19   | M 20 x 1.5 | 17,0      | 46,0       | 27,5       | 22         | 24 |
| GAR NW 08 HS VA     | S      | PN 400             | 12           | G 3/8" -19   | M 20 x 1.5 | 17,0      | 42,0       | 26,5       | 24         | 24 |
| GAR NW 08 HS 1/2 VA | S      | PN 400             | 12           | G 1/2" -14   | M 20 x 1.5 | 20,0      | 50,0       | 30,5       | 27         | 24 |
| GAR NW 10 HS VA     | S      | PN 400             | 14           | G 1/2" -14   | M 22 x 1.5 | 20,0      | 50,0       | 32,0       | 27         | 27 |
| GAR NW 13 HS VA     | S      | PN 400             | 16           | G 1/2" -14   | M 24 x 1.5 | 20,0      | 50,0       | 31,5       | 27         | 30 |
| GAR NW 16 HS 3/8 VA | S      | PN 315             | 20           | G 3/8" -19   | M 30 x 2   | 17,0      | 50,0       | 30,0       | 24         | 36 |
| GAR NW 16 HS 1/2 VA | S      | PN 315             | 20           | G 1/2" -14   | M 30 x 2   | 20,0      | 57,0       | 32,5       | 32         | 36 |
| GAR NW 16 HS VA     | S      | PN 315             | 20           | G 3/4" -14   | M 30 x 2   | 22,0      | 56,0       | 34,5       | 36         | 36 |
| GAR NW 20 HS VA     | S      | PN 315             | 25           | G 1" -11     | M 36 x 2   | 24,5      | 61,5       | 37,5       | 41         | 46 |
| GAR NW 25 HS VA     | S      | PN 315             | 30           | G 1.1/4" -11 | M 42 x 2   | 26,5      | 68,5       | 42,0       | 50         | 50 |
| GAR NW 32 HS VA     | S      | PN 250             | 38           | G 1.1/2" -11 | M 52 x 2   | 28,5      | 74,5       | 43,5       | 60         | 60 |

Series: LL = Very light L = Light S = Heavy - PN = Nominal pressure PB = Max. operating pressure - Ø d2 = External pipe diameter

## Product versions

|                |                                   |
|----------------|-----------------------------------|
| <b>GAR</b>     | Screw-on fitting, Steel           |
| <b>GAR MG</b>  | Screw-on fitting, Brass           |
| <b>XGAR VA</b> | Screw-on fitting, Stainless steel |