

TN VA

Screw-in fitting, T shaped

Properties

| | |
|---------------------------|--|
| Connection 1 | NPT external threads |
| Sealing form 1 | thread seal |
| Connection 2 + 3 | metric cylindrical outer thread |
| Sealing form 2 + 3 | 24° inner cone |
| Design | Screw-in fitting |
| Construction | T shaped |
| Standard | DIN 3865 |
| Scope of supply | Socket with union nut and cutting ring |
| Material | Stainless steel |

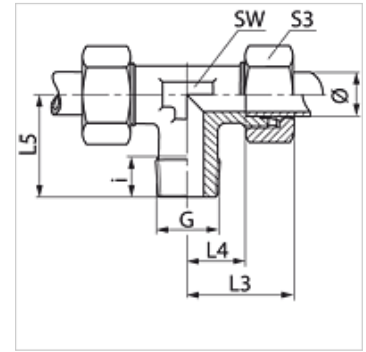

Note

Information about fitting, installation, pressure loads and permissible operating temperatures can be found in the technical information for pipe fittings.

Item

| Identification | Series | Operating pressure | External pipe Ø (mm) | G | i (mm) | L3 (mm) | L4 (mm) | L5 (mm) | AF (mm) | S3 |
|--------------------|--------|--------------------|-------------------------|------------------|-----------|------------|------------|------------|------------|----|
| TN 06 LL VA | LL | PN 100 | 6 | 1/8" -27 NPT | 8 | 21 | 9,5 | 17 | 9 | 12 |
| TN 08 LL VA | LL | PN 100 | 8 | 1/8" -27 NPT | 8 | 23 | 11,5 | 20 | 12 | 14 |
| TN NW 04 HL VA | L | PN 315 | 6 | 1/8" -27 NPT | 8 | 27 | 12,0 | 20 | 12 | 14 |
| TN NW 04 HL 1/4 VA | L | PN 315 | 6 | 1/4" -18 NPT | 10 | 27 | 12,0 | 20 | 12 | 14 |
| TN NW 06 HL VA | L | PN 315 | 8 | 1/4" -18 NPT | 12 | 29 | 14,0 | 26 | 12 | 17 |
| TN NW 08 HL VA | L | PN 315 | 10 | 1/4" -18 NPT | 12 | 30 | 15,0 | 27 | 14 | 19 |
| TN NW 08 HL 3/8 VA | L | PN 315 | 10 | 3/8" -18 NPT | 15 | 30 | 15,0 | 27 | 14 | 19 |
| TN NW 08 HL 1/2 VA | L | PN 315 | 10 | 1/2" -14 NPT | 20 | 37 | 21,0 | 33 | 17 | 19 |
| TN NW 10 HL 1/4 VA | L | PN 315 | 12 | 1/4" -18 NPT | 15 | 32 | 17,0 | 28 | 17 | 22 |
| TN NW 10 HL VA | L | PN 315 | 12 | 3/8" -18 NPT | 12 | 32 | 17,0 | 28 | 17 | 22 |
| TN NW 10 HL 1/2 VA | L | PN 315 | 12 | 1/2" -14 NPT | 20 | 36 | 21,0 | 34 | 17 | 22 |
| TN NW 13 HL VA | L | PN 315 | 15 | 1/2" -14 NPT | 14 | 36 | 21,0 | 34 | 19 | 27 |
| TN NW 16 HL VA | L | PN 315 | 18 | 1/2" -14 NPT | 14 | 40 | 23,5 | 36 | 24 | 32 |
| TN NW 20 HL VA | L | PN 160 | 22 | 3/4" -14 NPT | 16 | 44 | 27,5 | 42 | 27 | 36 |
| TN NW 25 HL VA | L | PN 160 | 28 | 1" -11.5 NPT | 16 | 47 | 30,5 | 48 | 36 | 41 |
| TN NW 32 HL VA | L | PN 160 | 35 | 1.1/4" -11.5 NPT | 20 | 56 | 34,5 | 54 | 41 | 50 |
| TN NW 40 HL VA | L | PN 160 | 42 | 1.1/2" -11.5 NPT | 22 | 63 | 40,0 | 61 | 50 | 60 |
| TN NW 03 HS VA | S | PN 630 | 6 | 1/4" -18 NPT | 12 | 31 | 16,0 | 26 | 12 | 17 |
| TN NW 04 HS VA | S | PN 630 | 8 | 1/4" -18 NPT | 12 | 32 | 17,0 | 27 | 14 | 19 |
| TN NW 06 HS VA | S | PN 630 | 10 | 3/8" -18 NPT | 12 | 34 | 17,5 | 28 | 17 | 22 |
| TN NW 08 HS VA | S | PN 630 | 12 | 3/8" -18 NPT | 12 | 38 | 21,5 | 28 | 17 | 24 |
| TN NW 08 HS 1/2 VA | S | PN 315 | 12 | 1/2" -14 NPT | 20 | 39 | 21,5 | 34 | 19 | 24 |
| TN NW 10 HS VA | S | PN 630 | 14 | 1/2" -14 NPT | 14 | 40 | 22,0 | 32 | 19 | 27 |
| TN NW 13 HS VA | S | PN 400 | 16 | 1/2" -14 NPT | 14 | 43 | 24,5 | 32 | 24 | 30 |
| TN NW 16 HS VA | S | PN 400 | 20 | 3/4" -14 NPT | 16 | 48 | 26,5 | 42 | 27 | 36 |
| TN NW 20 HS VA | S | PN 400 | 25 | 1" -11.5 NPT | 18 | 54 | 30,0 | 48 | 36 | 46 |
| TN NW 25 HS VA | S | PN 400 | 30 | 1.1/4" -11.5 NPT | 20 | 62 | 35,5 | 54 | 41 | 50 |
| TN NW 32 HS VA | S | PN 315 | 38 | 1.1/2" -11.5 NPT | 22 | 72 | 41,0 | 61 | 50 | 60 |

Series: LL = Very light L = Light S = Heavy - PN = Nominal pressure PB = Max. operating pressure - Ø = External pipe diameter

Product versions

| | |
|---------------|---|
| TN | Screw-in fitting, T shaped, Steel |
| XTN VA | Screw-in fitting, T shaped, Stainless steel |