

XDTM VA

Banjo fitting, throttle free, T shaped

HANSA FLEX

Properties

Connection 1	metric cylindrical outer thread
Sealing form 1	Edge sealing ring
Connection 2 + 3	metric cylindrical outer thread
Sealing form 2 + 3	24° inner cone
Design	Banjo coupling, throttle free
Construction	T shaped
Standard	ISO 8434-1
Scope of supply	Socket (without union nut and cutting ring)
Material	Stainless steel

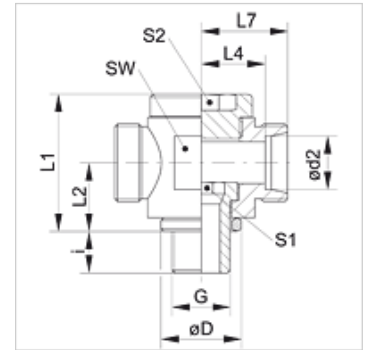
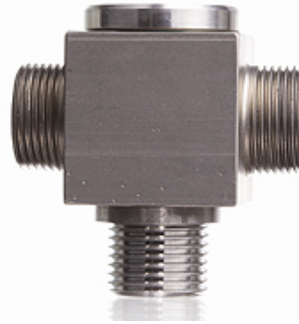

Note

Information about fitting, installation, pressure loads and permissible operating temperatures can be found in the technical information for pipe fittings.

Item

Identification	Series	Operating pressure	Ø d2 (mm)	G	Ø D (mm)	i (mm)	L1 (mm)	L2 (mm)	L4 (mm)	L7 (mm)	AF (mm)	S1	S2
XDTM NW 04 HL VA	L	PN 160	6	M 10 x 1	14,0	8	24	12	12,0	19	18	6	6
XDTM NW 06 HL VA	L	PN 160	8	M 12 x 1.5	17,0	12	27	14	13,0	20	20	6	6
XDTM NW 08 HL VA	L	PN 100	10	M 14 x 1.5	19,0	12	30	15	15,0	22	22	8	8
XDTM NW 10 HL VA	L	PN 100	12	M 16 x 1.5	21,0	12	36	18	17,5	24	27	10	10
XDTM NW 13 HL VA	L	PN 100	15	M 18 x 1.5	23,0	12	39	19	20,0	27	30	12	12
XDTM NW 16 HL VA	L	PN 100	18	M 22 x 1.5	27,0	14	41	20	20,5	28	32	14	14
XDTM NW 20 HL VA	L	PN 100	22	M 26 x 1.5	31,0	16	46	22	24,5	32	36	17	17
XDTM NW 25 HL VA	L	PN 100	28	M 33 x 2	39,0	18	58	29	29,5	37	46	22	22
XDTM NW 32 HL VA	L	PN 63	35	M 42 x 2	49,0	20	69	33	33,0	44	55	27	27
XDTM NW 40 HL VA	L	PN 63	42	M 48 x 2	55,0	22	84	41	40,0	51	65	32	32

Series: LL = Very light L = Light S = Heavy – PN = Nominal pressure PB = Max. operating pressure – Ø d2 = External pipe diameter

Product versions

XDTM	Banjo fitting, throttle free, T shaped, Socket (without union nut and cutting ring)
DTM VA	Banjo fitting, throttle free, T shaped, Socket with union nut and cutting ring