

### Properties

|                    |   |
|--------------------|---|
| Connection 1 - 3   | metric cylindrical outer thread             |
| Sealing form 1 - 3 | 24° inner cone                              |
| Design             | Reducing fitting                            |
| Construction       | T shaped                                    |
| Standard           | ISO 8434-1                                  |
| Scope of supply    | Socket (without union nut and cutting ring) |
| Material           | Steel                                       |
| Surface            | electro galvanised                          |

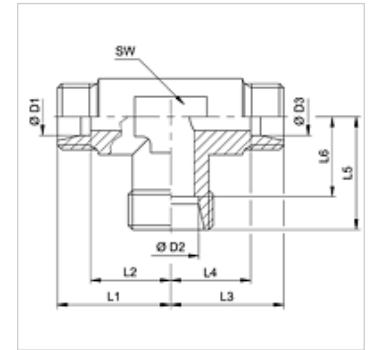

### Note

Information about fitting, installation, pressure loads and permissible operating temperatures can be found in the technical information for pipe fittings.

### Item

| Identification     | Series | Operating pressure | D1 (mm) | D2 (mm) | D3 (mm) | L1 (mm) | L2 (mm) | L3 (mm) | L4 (mm) | L5 (mm) | L6 (mm) | AF (mm) |
|--------------------|--------|--------------------|---------|---------|---------|---------|---------|---------|---------|---------|---------|---------|
| XRT 04 08 04 LL    | LL     | PN 100             | 4       | 8       | 4       | 17,0    | 13,0    | 17,0    | 13,0    | 17,0    | 11,5    | 12      |
| XRT 06 04 06 LL    | LL     | PN 100             | 6       | 4       | 6       | 15,0    | 9,5     | 15,0    | 9,5     | 15,0    | 11,0    | 11      |
| XRT NW 04 06 04 HL | L      | PN 315             | 6       | 8       | 6       | 21,0    | 14,0    | 21,0    | 14,0    | 21,0    | 14,0    | 12      |
| XRT NW 04 08 04 HL | L      | PN 315             | 6       | 10      | 6       | 22,0    | 15,0    | 22,0    | 15,0    | 22,0    | 15,0    | 14      |
| XRT NW 06 04 06 HL | L      | PN 315             | 8       | 6       | 8       | 29,0    | 14,0    | 21,0    | 14,0    | 21,0    | 21,0    | 12      |
| XRT NW 06 06 04 HL | L      | PN 315             | 8       | 8       | 6       | 21,0    | 14,0    | 21,0    | 14,0    | 21,0    | 14,0    | 14      |
| XRT NW 06 08 06 HL | L      | PN 315             | 8       | 10      | 8       | 22,0    | 15,0    | 22,0    | 15,0    | 22,0    | 15,0    | 14      |
| XRT NW 06 10 06 HL | L      | PN 315             | 8       | 12      | 8       | 24,0    | 17,0    | 24,0    | 17,0    | 24,0    | 17,0    | 17      |
| XRT NW 06 13 06 HL | L      | PN 315             | 8       | 15      | 8       | 21,0    | 14,0    | 21,0    | 14,0    | 21,0    | 14,0    | 19      |
| XRT NW 08 04 08 HL | L      | PN 315             | 10      | 6       | 10      | 22,0    | 15,0    | 22,0    | 15,0    | 22,0    | 15,0    | 14      |
| XRT NW 08 06 06 HL | L      | PN 315             | 10      | 8       | 8       | 22,0    | 15,0    | 22,0    | 15,0    | 22,0    | 15,0    | 17      |
| XRT NW 08 06 08 HL | L      | PN 315             | 10      | 8       | 10      | 22,0    | 15,0    | 22,0    | 15,0    | 22,0    | 15,0    | 14      |
| XRT NW 08 08 04 HL | L      | PN 315             | 10      | 10      | 6       | 22,0    | 15,0    | 22,0    | 15,0    | 22,0    | 15,0    | 14      |
| XRT NW 08 10 08 HL | L      | PN 315             | 10      | 12      | 10      | 24,0    | 17,0    | 24,0    | 17,0    | 24,0    | 17,0    | 19      |
| XRT NW 08 13 08 HL | L      | PN 315             | 10      | 15      | 10      | 28,0    | 21,0    | 28,0    | 21,0    | 28,0    | 21,0    | 19      |
| XRT NW 10 04 10 HL | L      | PN 315             | 12      | 6       | 12      | 24,0    | 17,0    | 24,0    | 17,0    | 24,0    | 17,0    | 17      |
| XRT NW 10 06 06 HL | L      | PN 315             | 12      | 8       | 8       | 24,0    | 17,0    | 24,0    | 17,0    | 24,0    | 17,0    | 17      |
| XRT NW 10 06 10 HL | L      | PN 315             | 12      | 8       | 12      | 24,0    | 17,0    | 24,0    | 17,0    | 24,0    | 17,0    | 17      |
| XRT NW 10 08 08 HL | L      | PN 315             | 12      | 10      | 10      | 24,0    | 17,0    | 24,0    | 17,0    | 24,0    | 17,0    | 17      |
| XRT NW 10 08 10 HL | L      | PN 315             | 12      | 10      | 12      | 24,0    | 17,0    | 24,0    | 17,0    | 24,0    | 17,0    | 17      |
| XRT NW 10 10 06 HL | L      | PN 315             | 12      | 12      | 8       | 24,0    | 17,0    | 24,0    | 17,0    | 24,0    | 17,0    | 19      |
| XRT NW 10 10 08 HL | L      | PN 315             | 12      | 12      | 10      | 24,0    | 17,0    | 24,0    | 17,0    | 24,0    | 17,0    | 17      |
| XRT NW 10 13 10 HL | L      | PN 315             | 12      | 15      | 12      | 28,0    | 21,0    | 28,0    | 21,0    | 28,0    | 21,0    | 19      |
| XRT NW 10 16 10 HL | L      | PN 315             | 12      | 18      | 12      | 31,0    | 24,0    | 31,0    | 24,0    | 31,0    | 23,5    | 24      |
| XRT NW 10 20 10 HL | L      | PN 160             | 12      | 22      | 12      | 35,0    | 28,0    | 35,0    | 28,0    | 35,0    | 27,5    | 27      |
| XRT NW 13 04 13 HL | L      | PN 315             | 15      | 6       | 15      | 28,0    | 21,0    | 28,0    | 21,0    | 28,0    | 21,0    | 19      |
| XRT NW 13 06 06 HL | L      | PN 315             | 15      | 8       | 8       | 28,0    | 21,0    | 28,0    | 21,0    | 28,0    | 21,0    | 19      |
| XRT NW 13 06 13 HL | L      | PN 315             | 15      | 8       | 15      | 28,0    | 21,0    | 28,0    | 21,0    | 28,0    | 21,0    | 19      |
| XRT NW 13 08 06 HL | L      | PN 315             | 15      | 10      | 8       | 28,0    | 21,0    | 28,0    | 21,0    | 28,0    | 21,0    | 19      |
| XRT NW 13 08 08 HL | L      | PN 315             | 15      | 10      | 10      | 28,0    | 21,0    | 28,0    | 21,0    | 28,0    | 21,0    | 19      |
| XRT NW 13 08 13 HL | L      | PN 315             | 15      | 10      | 15      | 28,0    | 21,0    | 28,0    | 21,0    | 28,0    | 21,0    | 19      |
| XRT NW 13 10 10 HL | L      | PN 315             | 15      | 12      | 12      | 28,0    | 21,0    | 28,0    | 21,0    | 28,0    | 21,0    | 19      |
| XRT NW 13 10 13 HL | L      | PN 315             | 15      | 12      | 15      | 28,0    | 21,0    | 28,0    | 21,0    | 28,0    | 21,0    | 19      |
| XRT NW 13 13 08 HL | L      | PN 315             | 15      | 15      | 10      | 28,0    | 21,0    | 28,0    | 21,0    | 28,0    | 21,0    | 19      |
| XRT NW 13 13 10 HL | L      | PN 315             | 15      | 15      | 12      | 28,0    | 21,0    | 28,0    | 21,0    | 28,0    | 21,0    | 19      |
| XRT NW 13 16 13 HL | L      | PN 315             | 15      | 18      | 15      | 31,0    | 24,0    | 31,0    | 24,0    | 31,0    | 23,5    | 24      |
| XRT NW 13 20 10 HL | L      | PN 160             | 15      | 22      | 12      | 35,0    | 28,0    | 35,0    | 28,0    | 35,0    | 27,5    | 27      |
| XRT NW 16 06 06 HL | L      | PN 315             | 18      | 8       | 8       | 31,5    | 24,0    | 31,0    | 24,0    | 30,5    | 23,5    | 24      |
| XRT NW 16 06 16 HL | L      | PN 315             | 18      | 8       | 18      | 31,0    | 23,5    | 31,0    | 23,5    | 31,0    | 24,0    | 24      |
| XRT NW 16 08 08 HL | L      | PN 315             | 18      | 10      | 10      | 31,0    | 23,5    | 31,0    | 24,0    | 31,0    | 24,0    | 24      |
| XRT NW 16 08 16 HL | L      | PN 315             | 18      | 10      | 18      | 31,0    | 23,5    | 31,0    | 23,5    | 31,0    | 24,0    | 24      |
| XRT NW 16 10 10 HL | L      | PN 315             | 18      | 12      | 12      | 31,0    | 23,5    | 31,0    | 24,0    | 31,0    | 24,0    | 24      |
| XRT NW 16 10 16 HL | L      | PN 315             | 18      | 12      | 18      | 31,0    | 23,5    | 31,0    | 23,5    | 31,0    | 24,0    | 24      |
| XRT NW 16 13 16 HL | L      | PN 315             | 18      | 15      | 18      | 31,0    | 23,5    | 31,0    | 23,5    | 31,0    | 24,0    | 24      |



| Item               |        |                    |         |         |         |         |         |         |         |         |         |         |
|--------------------|--------|--------------------|---------|---------|---------|---------|---------|---------|---------|---------|---------|---------|
| Identification     | Series | Operating pressure | D1 (mm) | D2 (mm) | D3 (mm) | L1 (mm) | L2 (mm) | L3 (mm) | L4 (mm) | L5 (mm) | L6 (mm) | AF (mm) |
| XRT NW 16 16 06 HL | L      | PN 315             | 18      | 18      | 8       | 31,0    | 23,5    | 30,5    | 23,5    | 31,0    | 23,5    | 24      |
| XRT NW 16 16 08 HL | L      | PN 315             | 18      | 18      | 10      | 31,0    | 23,5    | 31,0    | 24,0    | 31,0    | 23,5    | 24      |
| XRT NW 16 16 10 HL | L      | PN 315             | 18      | 18      | 12      | 31,0    | 23,5    | 30,5    | 23,5    | 31,5    | 24,0    | 24      |
| XRT NW 20 08 20 HL | L      | PN 160             | 22      | 10      | 22      | 35,0    | 27,5    | 35,0    | 27,5    | 35,0    | 28,0    | 27      |
| XRT NW 20 10 20 HL | L      | PN 160             | 22      | 12      | 22      | 35,0    | 27,5    | 35,0    | 27,5    | 35,0    | 28,0    | 27      |
| XRT NW 20 13 13 HL | L      | PN 160             | 22      | 15      | 15      | 35,0    | 27,5    | 35,0    | 28,0    | 35,0    | 28,0    | 27      |
| XRT NW 20 13 20 HL | L      | PN 160             | 22      | 15      | 22      | 35,0    | 27,5    | 35,0    | 27,5    | 35,0    | 28,0    | 27      |
| XRT NW 20 16 16 HL | L      | PN 160             | 22      | 18      | 18      | 35,0    | 27,5    | 35,0    | 27,5    | 35,0    | 27,5    | 27      |
| XRT NW 20 16 20 HL | L      | PN 160             | 22      | 18      | 22      | 35,0    | 27,5    | 35,0    | 27,5    | 35,0    | 27,5    | 27      |
| XRT NW 20 20 16 HL | L      | PN 160             | 22      | 22      | 18      | 35,0    | 27,5    | 35,0    | 27,5    | 35,0    | 27,5    | 27      |
| XRT NW 20 25 20 HL | L      | PN 160             | 22      | 28      | 22      | 38,0    | 30,5    | 38,0    | 30,5    | 38,0    | 30,5    | 36      |
| XRT NW 25 08 25 HL | L      | PN 160             | 28      | 10      | 28      | 38,0    | 30,5    | 38,0    | 30,5    | 38,0    | 31,0    | 36      |
| XRT NW 25 10 25 HL | L      | PN 160             | 28      | 12      | 28      | 38,0    | 30,5    | 38,0    | 30,5    | 38,0    | 31,0    | 36      |
| XRT NW 25 13 25 HL | L      | PN 160             | 28      | 15      | 28      | 38,0    | 30,5    | 38,0    | 30,5    | 38,0    | 31,0    | 36      |
| XRT NW 25 16 25 HL | L      | PN 160             | 28      | 18      | 28      | 38,0    | 30,5    | 38,0    | 30,5    | 38,0    | 30,5    | 36      |
| XRT NW 25 20 20 HL | L      | PN 160             | 28      | 22      | 22      | 38,0    | 30,5    | 38,0    | 30,5    | 38,0    | 30,5    | 36      |
| XRT NW 25 20 25 HL | L      | PN 160             | 28      | 22      | 28      | 38,0    | 30,5    | 38,0    | 30,5    | 38,0    | 30,5    | 36      |
| XRT NW 25 25 20 HL | L      | PN 160             | 28      | 28      | 22      | 38,0    | 30,5    | 38,0    | 30,5    | 38,0    | 30,5    | 36      |
| XRT NW 32 20 32 HL | L      | PN 160             | 35      | 22      | 35      | 45,0    | 34,5    | 45,0    | 34,5    | 45,0    | 37,5    | 41      |
| XRT NW 32 25 25 HL | L      | PN 160             | 35      | 28      | 28      | 45,0    | 34,5    | 45,0    | 37,5    | 45,0    | 37,5    | 41      |
| XRT NW 32 25 32 HL | L      | PN 160             | 35      | 28      | 35      | 45,0    | 34,5    | 45,0    | 34,5    | 45,0    | 37,5    | 41      |
| XRT NW 16 HL 16 HS | L / S  | PN 315             | 20      | 18      | 20      | 37,0    | 26,5    | 37,0    | 26,5    | 37,0    | 29,5    | 27      |
| XRT NW 04 03 04 HS | S      | PN 630             | 8       | 6       | 8       | 20,0    | 13,0    | 19,0    | 12,0    | 20,0    | 13,0    | 12      |
| XRT NW 06 03 06 HS | S      | PN 630             | 10      | 6       | 10      | 25,0    | 17,5    | 25,0    | 17,5    | 25,0    | 18,0    | 17      |
| XRT NW 08 03 08 HS | S      | PN 630             | 12      | 6       | 12      | 24,5    | 17,0    | 24,5    | 17,0    | 24,0    | 17,0    | 17      |
| XRT NW 08 04 04 HS | S      | PN 630             | 12      | 8       | 8       | 29,0    | 21,5    | 29,0    | 22,0    | 29,0    | 22,0    | 17      |
| XRT NW 08 04 08 HS | S      | PN 630             | 12      | 8       | 12      | 29,0    | 21,5    | 29,0    | 21,5    | 29,0    | 22,0    | 17      |
| XRT NW 08 06 08 HS | S      | PN 630             | 12      | 10      | 12      | 29,0    | 21,5    | 29,0    | 21,5    | 29,0    | 21,5    | 17      |
| XRT NW 08 13 08 HS | S      | PN 630             | 12      | 16      | 12      | 33,0    | 25,5    | 33,0    | 25,5    | 33,0    | 24,5    | 24      |
| XRT NW 10 06 10 HS | S      | PN 630             | 14      | 10      | 14      | 30,0    | 22,0    | 30,0    | 22,0    | 30,0    | 22,5    | 19      |
| XRT NW 13 03 13 HS | S      | PN 400             | 16      | 6       | 16      | 33,0    | 24,5    | 33,0    | 24,5    | 33,0    | 26,0    | 24      |
| XRT NW 13 04 13 HS | S      | PN 400             | 16      | 8       | 16      | 33,0    | 24,5    | 33,0    | 24,5    | 33,0    | 26,0    | 24      |
| XRT NW 13 06 13 HS | S      | PN 400             | 16      | 10      | 16      | 33,0    | 24,5    | 33,0    | 24,5    | 33,0    | 25,5    | 24      |
| XRT NW 13 08 13 HS | S      | PN 400             | 16      | 12      | 16      | 33,0    | 24,5    | 33,0    | 24,5    | 33,0    | 25,5    | 24      |
| XRT NW 13 16 13 HS | S      | PN 400             | 16      | 20      | 16      | 37,0    | 28,5    | 37,0    | 28,5    | 37,0    | 26,5    | 27      |
| XRT NW 16 06 16 HS | S      | PN 400             | 20      | 10      | 20      | 37,0    | 26,5    | 37,0    | 26,5    | 37,0    | 29,5    | 27      |
| XRT NW 16 08 16 HS | S      | PN 400             | 20      | 12      | 20      | 37,0    | 26,5    | 37,0    | 26,5    | 37,0    | 29,5    | 27      |
| XRT NW 16 10 16 HS | S      | PN 400             | 20      | 14      | 20      | 37,0    | 26,5    | 37,0    | 26,5    | 37,5    | 29,5    | 27      |
| XRT NW 16 13 16 HS | S      | PN 400             | 20      | 16      | 20      | 37,0    | 26,5    | 37,0    | 26,5    | 37,0    | 28,5    | 27      |
| XRT NW 16 16 20 HS | S      | PN 400             | 20      | 20      | 25      | 39,0    | 28,5    | 40,5    | 28,5    | 37,0    | 28,5    | 36      |
| XRT NW 16 20 16 HS | S      | PN 400             | 20      | 25      | 20      | 42,0    | 31,5    | 42,0    | 31,5    | 42,0    | 30,0    | 36      |
| XRT NW 20 13 20 HS | S      | PN 400             | 25      | 16      | 25      | 42,0    | 30,0    | 42,0    | 30,0    | 42,0    | 33,5    | 36      |
| XRT NW 20 16 20 HS | S      | PN 400             | 25      | 20      | 25      | 42,0    | 30,0    | 42,0    | 30,0    | 42,0    | 31,5    | 36      |
| XRT NW 20 25 20 HS | S      | PN 400             | 25      | 30      | 25      | 49,0    | 37,0    | 49,0    | 37,0    | 49,0    | 35,5    | 41      |
| XRT NW 25 13 25 HS | S      | PN 400             | 30      | 16      | 30      | 49,0    | 35,5    | 49,0    | 35,5    | 49,0    | 40,5    | 41      |
| XRT NW 25 16 25 HS | S      | PN 400             | 30      | 20      | 30      | 49,0    | 35,5    | 49,0    | 35,5    | 49,0    | 38,5    | 41      |
| XRT NW 25 20 25 HS | S      | PN 400             | 30      | 25      | 30      | 49,0    | 35,5    | 49,0    | 35,5    | 49,0    | 37,0    | 41      |

Series: LL = Very light L = Light S = Heavy - PN = Nominal pressure PB = Max. operating pressure - D1, D2, D3 = External pipe diameter - TGL = M 27 x 2

### Product versions

|        |  |
|--------|--|
| XRT VA | T shaped reducing fitting, Stainless steel |
| RT     | T shaped reducing fitting, Steel           |