

SA DKO

Welded on sealing cone

HANSA FLEX

Properties

Connection 1	Welded on socket for metric pipe
Sealing form 2	24° outer cone with O-ring
Design	Welded on sealing cone
Construction	straight
Standard	DIN 3865 ISO 8434-1
Material	Steel
Surface	phosphate treated and oiled (Znphr5f)

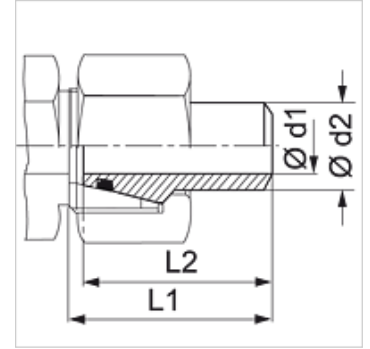

Note

Information about fitting, installation, pressure loads and permissible operating temperatures can be found in the technical information for pipe fittings.

Item

Identification	Series	Operating pressure	Ø d1 (mm)	Ø d2 (mm)	L1 (mm)	L2 (mm)	OR
SA NW 03 DKO 1.5	S	PN 528	3	6	32,5	31,0	4.0 x 1.5
SA NW 04 DKO 1.5	S	PN 414	5	8	32,0	30,0	6.0 x 1.5
SA NW 04 DKO 2	S	PN 528	4	8	31,5	31,0	6.0 x 1.5
SA NW 06 DKO 1	S	PN 249	8	10	33,5	32,5	7.5 x 1.5
SA NW 06 DKO 1.5	S	PN 358	7	10	33,5	31,5	7.5 x 1.5
SA NW 06 DKO 2	S	PN 460	6	10	33,5	31,5	7.5 x 1.5
SA NW 08 DKO 1.5	S	PN 305	9	12	33,5	31,5	9.0 x 1.5
SA NW 08 DKO 2	S	PN 393	8	12	33,5	31,5	9.0 x 1.5
SA NW 08 DKO 2.5	S	PN 476	7	12	33,5	31,5	9.0 x 1.5
SA NW 08 DKO 3	S	PN 551	6	12	33,5	32,5	9.0 x 1.5
SA NW 10 DKO 2	S	PN 343	10	14	40,0	37,5	10.0 x 2.0
SA NW 10 DKO 3	S	PN 487	8	14	39,5	38,5	10.0 x 2.0
SA NW 13 DKO 1.5	S	PN 234	13	16	40,5	37,5	12.0 x 2.0
SA NW 13 DKO 2	S	PN 305	12	16	40,5	37,5	12.0 x 2.0
SA NW 13 DKO 2.5	S	PN 372	11	16	40,5	37,5	12.0 x 2.0
SA NW 13 DKO 3	S	PN 400	10	16	40,5	37,5	12.0 x 2.0
SA NW 16 DKO 2	S	PN 249	16	20	47,0	43,5	16.3 x 2.4
SA NW 16 DKO 2.5	S	PN 305	15	20	46,5	43,0	16.3 x 2.4
SA NW 16 DKO 3	S	PN 358	14	20	46,5	43,0	16.3 x 2.4
SA NW 16 DKO 3.5	S	PN 400	13	20	47,5	43,5	16.3 x 2.4
SA NW 16 DKO 4	S	PN 400	12	20	46,5	43,0	16.3 x 2.4
SA NW 20 DKO 2	S	PN 201	21	25	53,0	48,0	20.3 x 2.4
SA NW 20 DKO 3	S	PN 294	19	25	53,0	48,0	20.3 x 2.4
SA NW 20 DKO 4	S	PN 379	17	25	53,0	48,0	20.3 x 2.4
SA NW 20 DKO 5	S	PN 400	15	25	53,0	48,0	20.3 x 2.4
SA NW 25 DKO 3	S	PN 249	24	30	57,5	51,5	25.3 x 2.4
SA NW 25 DKO 4	S	PN 323	22	30	57,5	51,5	25.3 x 2.4
SA NW 25 DKO 5	S	PN 393	20	30	57,5	51,5	25.3 x 2.4
SA NW 25 DKO 6	S	PN 400	18	30	57,0	52,0	25.3 x 2.4
SA NW 32 DKO 4	S	PN 261	30	38	64,0	55,0	33.3 x 2.4
SA NW 32 DKO 5	S	PN 315	28	38	64,0	55,0	33.3 x 2.4
SA NW 32 DKO 6	S	PN 315	26	38	64,0	55,0	33.3 x 2.4
SA NW 32 DKO 7	S	PN 315	24	38	64,0	56,5	33.3 x 2.4

Series: LL = Very light L = Light S = Heavy – PN = Nominal pressure PB = Max. operating pressure – Ø d2 = External pipe diameter

Product versions

SA DKO VA Welded on sealing cone, Stainless steel