

XSTOR VA

Banjo fitting, throttle free, T shaped

HANSA FLEX

Properties

| | |
|---------------------------|--|
| Connection 1 | BSP external thread, cylindrical |
| Sealing form 1 | Shape E |
| Connection 2 + 3 | metric cylindrical outer thread |
| Sealing form 2 + 3 | 24° inner cone |
| Design | Banjo couplings, throttle free (high pressure) |
| Construction | T shaped |
| Scope of supply | Socket (without union nut and cutting ring) |
| Material | Stainless steel |

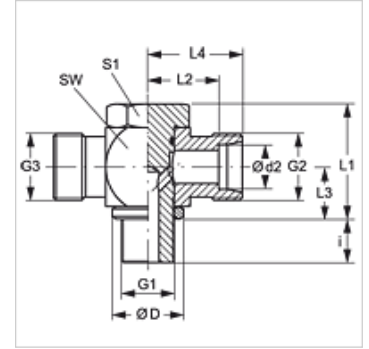

Note

Information about fitting, installation, pressure loads and permissible operating temperatures can be found in the technical information for pipe fittings.

Ordering information

Seals of NBR
FPM (Viton) on request

| Item | Series | Operating pres- sure | Ø d2 | G1 | G2 + G3 | Ø D | i | L1 | L2 | L3 | L4 | AF | S1 |
|-----------------------|--------|-------------------------|------|--------------|------------|------|------|------|------|------|------|------|----|
| | | | (mm) | | | (mm) | (mm) | (mm) | (mm) | (mm) | (mm) | (mm) | |
| XSTOR 04 LL VA | LL | PN 63 | 4 | G 1/8" -28 | M 8 x 1 | 14,0 | 8 | 24 | 11,0 | 8,0 | 15,0 | 18 | 17 |
| XSTOR 06 LL VA | LL | PN 63 | 6 | G 1/8" -28 | M 10 x 1 | 14,0 | 8 | 24 | 11,5 | 10,0 | 17,0 | 18 | 17 |
| XSTOR 08 LL VA | LL | PN 63 | 8 | G 1/8" -28 | M 12 x 1 | 14,0 | 8 | 24 | 11,5 | 10,0 | 17,0 | 18 | 17 |
| | | | | | | | | | | | | | |
| XSTOR NW 04 HL VA | L | PN 250 | 6 | G 1/8" -28 | M 12 x 1.5 | 14,0 | 8 | 24 | 12,0 | 10,5 | 19,0 | 17 | 17 |
| XSTOR NW 06 HL VA | L | PN 250 | 8 | G 1/4" -19 | M 14 x 1.5 | 18,0 | 12 | 30 | 14,5 | 14,0 | 22,0 | 22 | 19 |
| XSTOR NW 08 HL VA | L | PN 250 | 10 | G 1/4" -19 | M 16 x 1.5 | 18,0 | 12 | 30 | 15,5 | 14,0 | 22,0 | 22 | 19 |
| XSTOR NW 10 HL 1/4 VA | L | PN 250 | 12 | G 1/4" -19 | M 18 x 1.5 | 18,0 | 12 | 30 | 15,5 | 14,0 | 22,5 | 22 | 22 |
| XSTOR NW 10 HL VA | L | PN 250 | 12 | G 3/8" -19 | M 18 x 1.5 | 22,0 | 12 | 36 | 18,0 | 16,5 | 28,0 | 27 | 24 |
| XSTOR NW 13 HL VA | L | PN 250 | 15 | G 1/2" -14 | M 22 x 1.5 | 26,0 | 14 | 45 | 21,5 | 21,5 | 29,0 | 32 | 30 |
| XSTOR NW 16 HL VA | L | PN 315 | 18 | G 1/2" -14 | M 26 x 1.5 | 26,0 | 14 | 45 | 21,0 | 21,5 | 28,0 | 32 | 30 |
| XSTOR NW 20 HL VA | L | PN 160 | 22 | G 3/4" -14 | M 30 x 2 | 32,0 | 16 | 53 | 27,5 | 24,0 | 35,0 | 41 | 36 |
| XSTOR NW 25 HL VA | L | PN 160 | 28 | G 1" -11 | M 36 x 2 | 39,0 | 18 | 66 | 32,0 | 30,5 | 40,0 | 50 | 46 |
| XSTOR NW 32 HL VA | L | PN 160 | 35 | G 1.1/4" -11 | M 45 x 2 | 49,0 | 20 | 76 | 36,0 | 35,5 | 47,0 | 60 | 55 |
| XSTOR NW 40 HL VA | L | PN 160 | 42 | G 1.1/2" -11 | M 52 x 2 | 55,0 | 22 | 87 | 40,5 | 40,5 | 51,0 | 70 | 60 |
| | | | | | | | | | | | | | |
| XSTOR NW 03 HS VA | S | PN 315 | 6 | G 1/4" -19 | M 14 x 1.5 | 18,0 | 12 | 30 | 16,5 | 14,0 | 22,0 | 22 | 19 |
| XSTOR NW 04 HS VA | S | PN 315 | 8 | G 1/4" -19 | M 16 x 1.5 | 18,0 | 12 | 30 | 16,5 | 14,0 | 22,0 | 22 | 19 |
| XSTOR NW 06 HS 1/4 VA | S | PN 315 | 10 | G 1/4" -19 | M 18 x 1.5 | 18,0 | 12 | 30 | 16,5 | 14,0 | 24,0 | 22 | 22 |
| XSTOR NW 06 HS VA | S | PN 315 | 10 | G 3/8" -19 | M 18 x 1.5 | 22,0 | 12 | 36 | 18,5 | 16,5 | 26,0 | 27 | 24 |
| XSTOR NW 08 HS VA | S | PN 315 | 12 | G 3/8" -19 | M 20 x 1.5 | 22,0 | 12 | 36 | 18,5 | 16,5 | 27,0 | 27 | 24 |
| XSTOR NW 10 HS VA | S | PN 315 | 14 | G 1/2" -14 | M 22 x 1.5 | 32,0 | 15 | 45 | 22,5 | 21,5 | 30,0 | 32 | 27 |
| XSTOR NW 13 HS VA | S | PN 315 | 16 | G 1/2" -14 | M 24 x 1.5 | 26,0 | 14 | 45 | 22,0 | 21,5 | 30,0 | 32 | 30 |
| XSTOR NW 16 HS VA | S | PN 160 | 20 | G 3/4" -14 | M 30 x 2 | 32,0 | 16 | 53 | 26,5 | 24,0 | 37,0 | 41 | 36 |
| XSTOR NW 20 HS VA | S | PN 160 | 25 | G 1" -11 | M 36 x 2 | 39,0 | 18 | 66 | 31,5 | 30,5 | 44,0 | 50 | 46 |
| XSTOR NW 25 HS VA | S | PN 160 | 30 | G 1.1/4" -11 | M 42 x 2 | 49,0 | 20 | 76 | 37,0 | 35,5 | 51,0 | 60 | 55 |
| XSTOR NW 32 HS VA | S | PN 160 | 38 | G 1.1/2" -11 | M 52 x 2 | 55,0 | 22 | 87 | 41,5 | 40,5 | 57,0 | 70 | 60 |

Series: LL = Very light L = Light S = Heavy - PN = Nominal pressure PB = Max. operating pressure - Ø d2 = External pipe diameter

Product versions

STOR VA Banjo fitting, throttle free, T shaped, Socket with union nut and cutting ring