

XSTR

Banjo fitting, throttle free, T shaped

HANSA FLEX

Properties

Connection 1	BSP external thread, cylindrical
Sealing form 1	Edge sealing ring
Connection 2 + 3	metric cylindrical outer thread
Sealing form 2 + 3	24° inner cone
Design	Banjo coupling, throttle free
Construction	T shaped
Standard	ISO 8434-1
Scope of supply	Socket (without union nut and cutting ring)
Material	Steel
Surface	electro galvanised

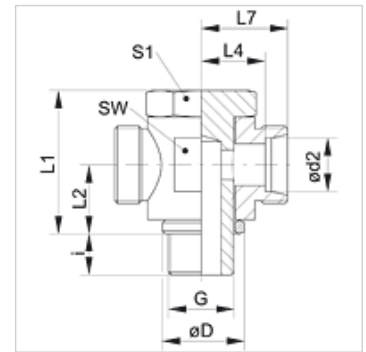

Note

Information about fitting, installation, pressure loads and permissible operating temperatures can be found in the technical information for pipe fittings.

Item

Identification	Series	Operating pressure	Ø d2 (mm)	G	Ø D (mm)	i (mm)	L1 (mm)	L2 (mm)	L4 (mm)	L7 (mm)	AF (mm)	S1
XSTR NW 04 HL	L	PN 250	6	G 1/8" -28	14	8	24	10,5	12,0	19,0	17	17
XSTR NW 06 HL	L	PN 250	8	G 1/4" -19	18	12	30	14,0	14,5	21,5	22	19
XSTR NW 08 HL	L	PN 250	10	G 1/4" -19	18	12	30	14,0	15,5	22,5	22	19
XSTR NW 10 HL	L	PN 250	12	G 3/8" -19	22	12	36	16,5	18,0	25,0	27	24
XSTR NW 13 HL	L	PN 250	15	G 1/2" -14	26	14	45	21,5	21,5	28,5	32	30
XSTR NW 16 HL	L	PN 250	18	G 1/2" -14	26	14	45	21,5	21,0	28,5	32	30
XSTR NW 20 HL	L	PN 160	22	G 3/4" -14	32	16	53	24,0	27,5	35,0	41	36
XSTR NW 25 HL	L	PN 160	28	G 1" -11	39	18	66	30,5	32,0	39,5	50	46
XSTR NW 32 HL	L	PN 160	35	G 1.1/4" -11	49	20	76	35,5	36,0	46,5	60	55
XSTR NW 40 HL	L	PN 160	42	G 1.1/2" -11	55	22	87	40,5	40,5	51,5	70	60
XSTR NW 03 HS	S	PN 315	6	G 1/4" -19	18	12	30	14,0	16,5	23,5	22	19
XSTR NW 04 HS	S	PN 315	8	G 1/4" -19	18	12	30	14,0	16,5	23,5	22	19
XSTR NW 06 HS	S	PN 315	10	G 3/8" -19	22	12	36	16,5	18,5	26,0	27	24
XSTR NW 08 HS	S	PN 315	12	G 3/8" -19	22	12	36	16,5	18,5	26,0	27	24
XSTR NW 10 HS	S	PN 315	14	G 1/2" -14	26	14	45	21,5	22,5	30,5	32	30
XSTR NW 13 HS	S	PN 315	16	G 1/2" -14	26	14	45	21,5	22,0	30,5	32	30
XSTR NW 16 HS	S	PN 160	20	G 3/4" -14	32	16	53	24,0	26,5	37,0	41	36
XSTR NW 20 HS	S	PN 160	25	G 1" -11	39	18	66	30,5	31,5	43,5	50	46
XSTR NW 25 HS	S	PN 160	30	G 1.1/4" -11	49	20	76	35,5	37,0	50,5	60	55
XSTR NW 32 HS	S	PN 160	38	G 1.1/2" -11	55	22	87	40,5	41,5	57,5	70	60

Series: LL = Very light L = Light S = Heavy - PN = Nominal pressure PB = Max. operating pressure - Ø d2 = External pipe diameter

Product versions

STR Banjo fitting, throttle free, T shaped, Socket with union nut and cutting ring