

SA DKOL VA

Welded on sealing cone

Properties

Connection 1	Welded on socket for metric pipe
Sealing form 2	24° outer cone with O-ring
Design	Welded on sealing cone
Construction	straight
Standard	DIN 3865
Material	Stainless steel

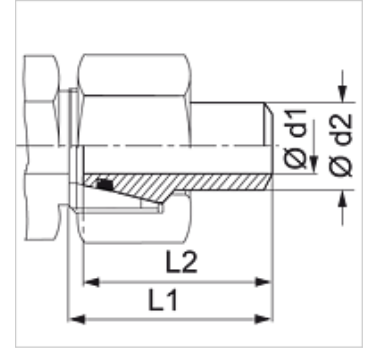

Note

Information about fitting, installation, pressure loads and permissible operating temperatures can be found in the technical information for pipe fittings.

Ordering information

Seals of NBR
FPM (Viton) on request

Item

Identification	Series	Operating pressure	Ø d1 (mm)	Ø d2 (mm)	L1 (mm)	L2 (mm)	OR
SA NW 13 DKOL 1.5 VA	L	PN 270	12	15	38,0	36,0	12.0 x 2.0
SA NW 13 DKOL 2 VA	L	PN 315	11	15	38,0	36,0	12.0 x 2.0
SA NW 13 DKOL 2.5 VA	L	PN 315	10	15	35,0	34,5	12.0 x 2.0
SA NW 16 DKOL 1.5 VA	L	PN 225	15	18	39,0	37,0	15.0 x 2.0
SA NW 16 DKOL 2.0 VA	L	PN 300	14	18	39,0	37,0	15.0 x 2.0
SA NW 16 DKOL 2.5 VA	L	PN 315	13	18	37,0	36,0	15.0 x 2.0
SA NW 20 DKOL 2.0 VA	L	PN 160	18	22	40,5	38,5	20.0 x 2.0
SA NW 20 DKOL 2.5 VA	L	PN 160	17	22	39,5	37,5	20.0 x 2.0
SA NW 20 DKOL 3.0 VA	L	PN 160	16	22	40,5	38,5	20.0 x 2.0
SA NW 25 DKOL 2.0 VA	L	PN 160	24	28	43,5	41,5	26.0 x 2.0
SA NW 25 DKOL 2.5 VA	L	PN 160	23	28	53,0	48,0	26.0 x 2.0
SA NW 25 DKOL 3 VA	L	PN 160	22	28	42,5	47,0	26.0 x 2.0
SA NW 32 DKOL 2.0 VA	L	PN 154	31	35	49,0	47,0	32.0 x 2.5
SA NW 32 DKOL 2.5 VA	L	PN 160	30	35	49,0	47,0	32.0 x 2.5
SA NW 32 DKOL 3.0 VA	L	PN 160	29	35	49,0	47,0	32.0 x 2.5
SA NW 32 DKOL 3.5 VA	L	PN 160	28	35	49,5	47,0	32.0 x 2.5
SA NW 32 DKOL 4 VA	L	PN 160	27	35	49,0	47,0	32.0 x 2.5
SA NW 40 DKOL 2.0 VA	L	PN 160	38	42	49,0	47,0	38.0 x 2.5
SA NW 40 DKOL 2.5 VA	L	PN 160	37	42	49,0	47,0	38.0 x 2.5
SA NW 40 DKOL 3 VA	L	PN 160	36	42	50,0	47,0	38.0 x 2.5
SA NW 40 DKOL 4 VA	L	PN 160	34	42	49,0	47,0	38.0 x 2.5

Series: LL = Very light L = Light S = Heavy - PN = Nominal pressure PB = Max. operating pressure - d2 = for external pipe diameter

Product versions

SA DKOL Welded on sealing cone, Steel