

Properties

Connection 1	metric cylindrical outer thread
Sealing form 1	Shape B
Connection 2 + 3	metric cylindrical outer thread
Sealing form 2 + 3	24° inner cone
Design	Screw-in fitting
Construction	T shaped
Standard	DIN 2353 ISO 8434-1
Scope of supply	Socket (without union nut and cutting ring)
Material	Steel
Surface	electro galvanised

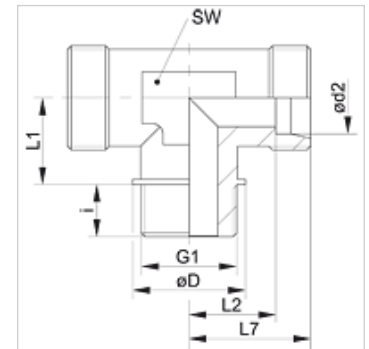

Note

Information about fitting, installation, pressure loads and permissible operating temperatures can be found in the technical information for pipe fittings.

Item

Identification	Series	Operating pressure	Ø d2 (mm)	G	Ø D (mm)	i (mm)	L1 (mm)	L2 (mm)	L7 (mm)	AF (mm)
XTM NW 20 HL	L	PN 160	22	M 26 x 1.5	31,0	16	26	27,5	35	27
XTM NW 25 HL	L	PN 160	28	M 33 x 2	39,0	18	30	30,5	38	36
XTM NW 32 HL	L	PN 160	35	M 42 x 2	49,0	20	34	34,5	45	41
XTM NW 40 HL	L	PN 160	42	M 48 x 2	55,0	22	39	41,0	51	50
XTM NW 16 HS	S	PN 400	20	M 27 x 2	32,0	16	26	26,5	39	27
XTM NW 20 HS	S	PN 250	25	M 33 x 2	39,0	18	30	30,0	42	36
XTM NW 25 HS	S	PN 160	30	M 42 x 2	49,0	20	34	35,5	49	41
XTM NW 32 HS	S	PN 160	38	M 48 x 2	55,0	22	39	41,0	57	50

Series: LL = Very light L = Light S = Heavy – PN = Nominal pressure PB = Max. operating pressure – Ø d2 = External pipe diameter

Product versions

XTM VA	Screw-in fitting, T shaped, Stainless steel
TM	Screw-in fitting, T shaped, Steel