

XTM VA

Screw-in fitting, T shaped

HANSA FLEX

Properties

Connection 1	metric cylindrical outer thread
Sealing form 1	Shape B
Connection 2 + 3	metric cylindrical outer thread
Sealing form 2 + 3	24° inner cone
Design	Screw-in fitting
Construction	T shaped
Standard	DIN 3907
Scope of supply	Socket (without union nut and cutting ring)
Material	Stainless steel

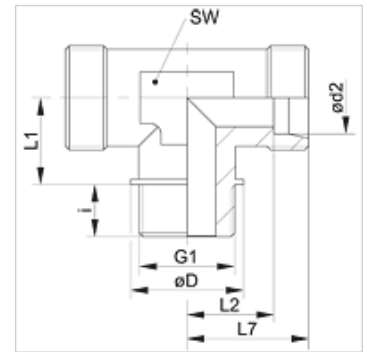

Note

Information about fitting, installation, pressure loads and permissible operating temperatures can be found in the technical information for pipe fittings.

Item

Identification	Series	Operating pressure	Ø d2 (mm)	G	Ø D (mm)	i (mm)	L1 (mm)	L2 (mm)	L7 (mm)	AF (mm)
XTM NW 20 HL VA	L	PN 160	22	M 26 x 1.5	31,0	16	26	27,5	35	27
XTM NW 25 HL VA	L	PN 160	28	M 33 x 2	39,0	18	30	30,5	38	36
XTM NW 32 HL VA	L	PN 160	35	M 42 x 2	49,0	20	34	34,5	45	41
XTM NW 40 HL VA	L	PN 160	42	M 48 x 2	55,0	22	39	41,0	51	50
XTM NW 16 HS VA	S	PN 400	20	M 27 x 2	32,0	16	26	26,5	39	27
XTM NW 20 HS VA	S	PN 250	25	M 33 x 2	39,0	18	30	30,0	42	36
XTM NW 25 HS VA	S	PN 160	30	M 42 x 2	49,0	20	34	35,5	49	41
XTM NW 32 HS VA	S	PN 160	38	M 48 x 2	55,0	22	39	41,0	57	50

Series: LL = Very light L = Light S = Heavy – PN = Nominal pressure PB = Max. operating pressure – Ø d2 = External pipe diameter

Product versions

XTM	Screw-in fitting, T shaped, Steel
TM VA	Screw-in fitting, T shaped, Stainless steel