

XTMK VA

Screw-in fitting, T shaped

Properties

Connection 1	metric conical outer thread
Sealing form 1	thread seal
Connection 2 + 3	metric cylindrical outer thread
Sealing form 2 + 3	24° inner cone
Design	Screw-in fitting
Construction	T shaped
Standard	DIN 3906
Scope of supply	Socket (without union nut and cutting ring)
Material	Stainless steel

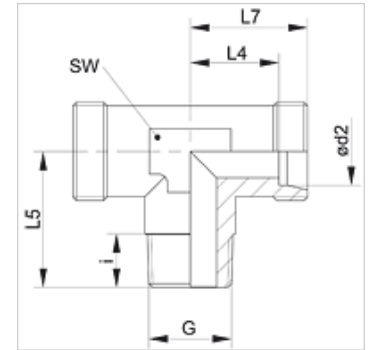

Note

Information about fitting, installation, pressure loads and permissible operating temperatures can be found in the technical information for pipe fittings.

Item

Identification	Series	Operating pressure	Ø d2 (mm)	G	i (mm)	L4 (mm)	L5 (mm)	L7 (mm)	AF (mm)
XTM 04 LL VA	LL	PN 100	4	M 8 x 1 K	8	11,0	17	15	9
XTM 04 LL 6 VA	LL	PN 100	4	M 6 x 1 K	8	11,0	17	15	9
XTM 06 LL VA	LL	PN 100	6	M 10 x 1 K	8	9,5	17	15	9
XTM 06 LL 6 VA	LL	PN 100	6	M 6 x 1 K	8	9,5	17	15	9
XTM 06 LL 8 VA	LL	PN 100	6	M 8 x 1 K	8	9,5	17	15	9
XTM 06 LL 10 VA	LL	PN 100	6	M 10 x 1 K	8	9,5	17	15	9
XTM 08 LL VA	LL	PN 100	8	M 10 x 1 K	8	11,5	20	17	12
XTM NW 04 HL VA	L	PN 315	6	M 10 x 1 K	8	12,0	20	19	12
XTM NW 06 HL VA	L	PN 315	8	M 12 x 1.5 K	12	14,0	26	21	12
XTM NW 08 HL VA	L	PN 315	10	M 14 x 1.5 K	12	15,0	27	22	14
XTM NW 10 HL VA	L	PN 315	12	M 16 x 1.5 K	12	17,0	28	24	17
XTM NW 13 HL VA	L	PN 315	15	M 18 x 1.5 K	12	21,0	32	28	19
XTM NW 16 HL VA	L	PN 315	18	M 22 x 1.5 K	14	23,5	34	31	24
XTM NW 03 HS VA	S	PN 400	6	M 12 x 1.5 K	12	16,0	26	23	12
XTM NW 04 HS VA	S	PN 400	8	M 14 x 1.5 K	12	17,0	26	24	14
XTM NW 06 HS VA	S	PN 400	10	M 16 x 1.5 K	12	17,5	27	25	17
XTM NW 08 HS VA	S	PN 400	12	M 18 x 1.5 K	12	21,5	28	29	19
XTM NW 10 HS VA	S	PN 400	14	M 20 x 1.5 K	14	22,0	32	30	19
XTM NW 13 HS VA	S	PN 400	16	M 22 x 1.5 K	14	24,5	32	33	24

Series: LL = Very light L = Light S = Heavy - PN = Nominal pressure PB = Max. operating pressure - Ø = External pipe diameter

Product versions

XTMK	Screw-in fitting, T shaped, Steel
TMK VA	Screw-in fitting, T shaped, Stainless steel