

Properties

Connection 1	NPT external threads
Sealing form 1	thread seal
Connection 2 + 3	metric cylindrical outer thread
Sealing form 2 + 3	24° inner cone
Design	Screw-in fitting
Construction	T shaped
Standard	DIN 2353
Scope of supply	Socket (without union nut and cutting ring)
Material	Steel
Surface	electro galvanised

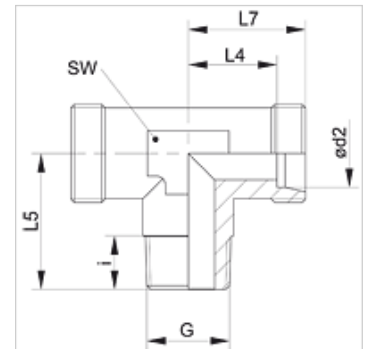

Note

Information about fitting, installation, pressure loads and permissible operating temperatures can be found in the technical information for pipe fittings.

Item

Identification	Series	Operating pressure	Ø d2 (mm)	G	i (mm)	L4 (mm)	L5 (mm)	L7 (mm)	AF (mm)
XTN 04 LL	LL	PN 100	4	1/8" -27 NPT	8	11,0	17	15	9
XTN 05 LL	LL	PN 100	5	1/8" -27 NPT	8	9,5	17	15	9
XTN 06 LL	LL	PN 100	6	1/8" -27 NPT	8	9,5	17	15	9
XTN 08 LL	LL	PN 100	8	1/8" -27 NPT	8	11,5	20	17	12
XTN NW 04 HL	L	PN 315	6	1/8" -27 NPT	8	12,0	20	19	12
XTN NW 04 HL 1/4	L	PN 315	6	1/4" -18 NPT	12	12,0	25	19	12
XTN NW 06 HL	L	PN 315	8	1/4" -18 NPT	12	14,0	26	21	12
XTN NW 08 HL	L	PN 315	10	1/4" -18 NPT	12	15,0	27	22	14
XTN NW 10 HL	L	PN 315	12	3/8" -18 NPT	12	17,0	28	24	17
XTN NW 13 HL	L	PN 315	15	1/2" -14 NPT	14	21,0	34	26	19
XTN NW 16 HL	L	PN 315	18	1/2" -14 NPT	14	23,5	36	31	24
XTN NW 20 HL	L	PN 160	22	3/4" -14 NPT	16	27,5	42	35	27
XTN NW 25 HL	L	PN 160	28	1" -11.5 NPT	18	30,5	48	38	36
XTN NW 32 HL	L	PN 160	35	1.1/4" -11.5 NPT	20	34,5	54	45	41
XTN NW 40 HL	L	PN 160	42	1.1/2" -11.5 NPT	22	40,0	61	51	50
XTN NW 03 HS	S	PN 630	6	1/4" -18 NPT	12	16,0	26	23	12
XTN NW 04 HS	S	PN 630	8	1/4" -18 NPT	12	17,0	27	24	14
XTN NW 06 HS	S	PN 630	10	3/8" -18 NPT	12	17,5	28	35	17
XTN NW 08 HS	S	PN 630	12	3/8" -18 NPT	12	21,5	31	30	17
XTN NW 10 HS	S	PN 630	14	1/2" -14 NPT	14	22,0	32	30	19
XTN NW 13 HS	S	PN 400	16	1/2" -14 NPT	14	24,5	32	33	24
XTN NW 16 HS	S	PN 400	20	3/4" -14 NPT	16	26,5	42	37	27
XTN NW 20 HS	S	PN 400	25	1" -11.5 NPT	18	30,0	48	42	36
XTN NW 25 HS	S	PN 400	30	1.1/4" -11.5 NPT	20	35,5	54	49	41
XTN NW 32 HS	S	PN 315	38	1.1/2" -11.5 NPT	22	41,0	61	57	50

Series: LL = Very light L = Light S = Heavy - PN = Nominal pressure PB = Max. operating pressure - Ø = External pipe diameter

Product versions

XTN VA	Screw-in fitting, T shaped, Stainless steel
TN	Screw-in fitting, T shaped, Steel