

Properties

Connection 1	BSP external thread, cylindrical
Sealing form 1	Shape B
Connection 2 + 3	metric cylindrical outer thread
Sealing form 2 + 3	24° inner cone
Design	Screw-in fitting
Construction	T shaped
Standard	DIN 2353 ISO 8434-1
Scope of supply	Socket (without union nut and cutting ring)
Material	Steel
Surface	electro galvanised

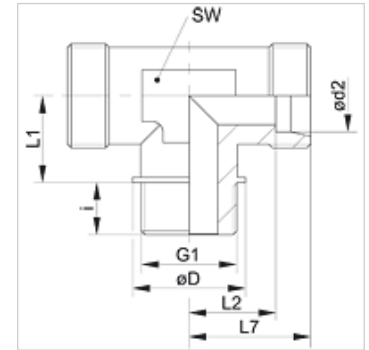

Note

Information about fitting, installation, pressure loads and permissible operating temperatures can be found in the technical information for pipe fittings.

Item

Identification	Series	Operating pressure	Ø d2 (mm)	G1	Ø D (mm)	i (mm)	L1 (mm)	L2 (mm)	L7 (mm)	AF (mm)
XTR NW 20 HL	L	PN 160	22	G 3/4" -14	31,0	16	26	27,5	35	27
XTR NW 25 HL	L	PN 160	28	G 1" -11	39,0	18	30	30,5	38	36
XTR NW 32 HL	L	PN 160	35	G 1.1/4" -11	49,0	20	34	34,5	45	41
XTR NW 40 HL	L	PN 160	42	G 1.1/2" -11	55,0	22	39	40,0	51	50
XTR NW 16 HS	S	PN 400	20	G 3/4" -14	32,0	16	26	26,5	37	27
XTR NW 20 HS	S	PN 250	25	G 1" -11	39,0	18	30	30,0	42	36
XTR NW 25 HS	S	PN 160	30	G 1.1/4" -11	49,0	20	34	35,5	49	41
XTR NW 32 HS	S	PN 160	38	G 1.1/2" -11	55,0	22	39	41,0	57	50

PN = Nominal pressure PB = Max. operating pressure – Series: LL = Very light L = Light S = Heavy – Ø d2 = External pipe diameter

Product versions

XTR VA	Screw-in fitting, T shaped, Stainless steel
TR	Screw-in fitting, T shaped, Steel