

# XTR VA

Screw-in fitting, T shaped

**HANSA FLEX**

## Properties

<b>Connection 1</b>	BSP external thread, cylindrical
<b>Sealing form 1</b>	Shape B
<b>Connection 2 + 3</b>	metric cylindrical outer thread
<b>Sealing form 2 + 3</b>	24° inner cone
<b>Design</b>	Screw-in fitting
<b>Construction</b>	T shaped
<b>Standard</b>	DIN 3907
<b>Scope of supply</b>	Socket (without union nut and cutting ring)
<b>Material</b>	Stainless steel

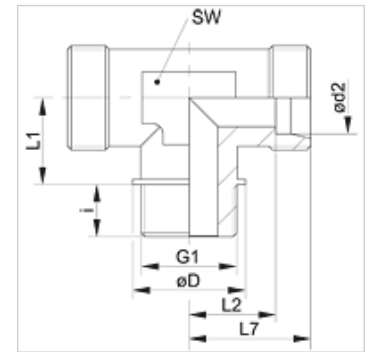

## Note

Information about fitting, installation, pressure loads and permissible operating temperatures can be found in the technical information for pipe fittings.

## Item

Identification	Series	Operating pressure	Ø d2 (mm)	G1	Ø D (mm)	i (mm)	L1 (mm)	L2 (mm)	L7 (mm)	AF (mm)
XTR NW 20 HL VA	L	PN 160	22	G 3/4" -14	31,0	16	26	27,5	35	27
XTR NW 25 HL VA	L	PN 160	28	G 1" -11	39,0	18	30	30,5	38	36
XTR NW 32 HL VA	L	PN 160	35	G 1.1/4" -11	49,0	20	34	34,5	45	41
XTR NW 40 HL VA	L	PN 160	42	G 1.1/2" -11	55,0	22	39	40,0	51	50
XTR NW 16 HS VA	S	PN 400	20	G 3/4" -14	32,0	16	26	26,5	37	27
XTR NW 20 HS VA	S	PN 250	25	G 1" -11	39,0	18	30	30,0	42	36
XTR NW 25 HS VA	S	PN 160	30	G 1.1/4" -11	49,0	20	34	35,5	49	41
XTR NW 32 HS VA	S	PN 160	38	G 1.1/2" -11	55,0	22	39	41,0	57	50

PN = Nominal pressure PB = Max. operating pressure – Series: LL = Very light L = Light S = Heavy – Ø d2 = External pipe diameter

## Product versions

<b>XTR</b>	Screw-in fitting, T shaped, Steel
<b>TR VA</b>	Screw-in fitting, T shaped, Stainless steel