

XTRK VA

Screw-in fitting, T shaped

Properties

Connection 1	BSPT conical external threads
Sealing form 1	thread seal
Connection 2 + 3	metric cylindrical outer thread
Sealing form 2 + 3	24° inner cone
Design	Screw-in fitting
Construction	T shaped
Standard	DIN 3906
Scope of supply	Socket (without union nut and cutting ring)
Material	Stainless steel

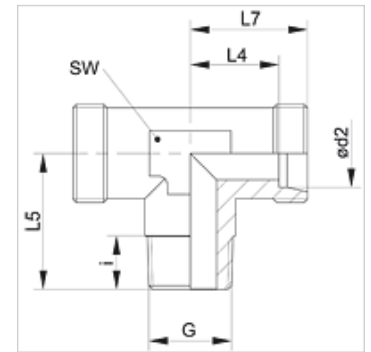

Item

Identification	Series	Operating pressure	Ø d2 (mm)	G	i (mm)	L4 (mm)	L5 (mm)	L7 (mm)	AF (mm)
XTR 04 LL VA	LL	PN 100	4	R 1/8" K	8	11,0	17	15	9
XTR 06 LL VA	LL	PN 100	6	R 1/8" K	8	9,5	17	15	9
XTR 08 LL VA	LL	PN 100	8	R 1/8" K	8	11,5	20	17	12
XTR NW 04 HL VA	L	PN 315	6	R 1/8" K	8	12,0	20	19	12
XTR NW 04 HL 1/4 VA	L	PN 315	6	R 1/4" K	12	14,0	26	21	12
XTR NW 06 HL VA	L	PN 315	8	R 1/4" K	12	14,0	26	21	12
XTR NW 06 HL 3/8 VA	L	PN 315	8	R 3/8" K	12	15,0	28	22	14
XTR NW 08 HL VA	L	PN 315	10	R 1/4" K	12	15,0	27	22	14
XTR NW 08 HL 3/8 VA	L	PN 315	10	R 3/8" K	12	15,0	27	22	17
XTR NW 08 HL 1/2 VA	L	PN 315	10	R 1/2" K	14	21,0	33	29	17
XTR NW 10 HL 1/4 VA	L	PN 315	12	R 1/4" K	12	17,0	28	24	17
XTR NW 10 HL VA	L	PN 315	12	R 3/8" K	12	17,0	28	24	17
XTR NW 10 HL 1/2 VA	L	PN 315	12	R 1/2" K	14	20,5	34	29	17
XTR NW 13 HL VA	L	PN 315	15	R 1/2" K	14	21,0	34	28	19
XTR NW 16 HL VA	L	PN 315	18	R 1/2" K	14	23,5	34	31	24
XTR NW 03 HS VA	S	PN 400	6	R 1/4" K	12	16,0	26	23	12
XTR NW 04 HS VA	S	PN 400	8	R 1/4" K	12	17,0	26	24	14
XTR NW 06 HS VA	S	PN 400	10	R 3/8" K	12	17,5	27	25	17
XTR NW 08 HS VA	S	PN 400	12	R 3/8" K	12	21,5	28	29	19
XTR NW 08 HS 1/2 VA	S	PN 400	12	R 1/2" K	14	21,5	34	29	19
XTR NW 10 HS VA	S	PN 400	14	R 1/2" K	14	22,0	32	30	19
XTR NW 13 HS VA	S	PN 400	16	R 1/2" K	14	24,5	32	33	24

Series: LL = Very light L = Light S = Heavy – PN = Nominal pressure PB = Max. operating pressure – Ø = External pipe diameter

Product versions

XTRK	Screw-in fitting, T shaped, Steel
TRK VA	Screw-in fitting, T shaped, Stainless steel