

Properties

Connection 1	metric nut thread
Sealing form 1	Pipe socket with cutting ring
Connection 2 + 3	metric cylindrical outer thread
Sealing form 2 + 3	24° inner cone
Design	Adjustable direction fitting
Construction	T shaped
Standard	DIN 2353 ISO 8434-1
Scope of supply	Socket (without union nut and cutting ring) pre-assembled
Material	Steel
Surface	electro galvanised

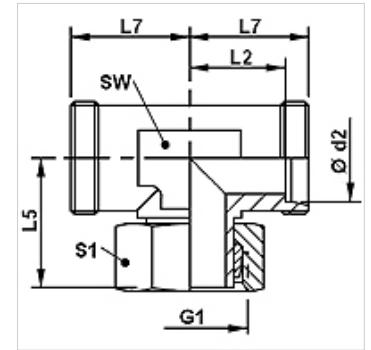

Note

Information about fitting, installation, pressure loads and permissible operating temperatures can be found in the technical information for pipe fittings.

Item

Identification	Series	Operating pressure	Ø d2 (mm)	G1	L2 (mm)	L5 (mm)	L7 (mm)	AF (mm)	S1
XVET NW 04 HL	L	PN 315	6	M 12 x 1.5	12,0	26,0	19	12	14
XVET NW 06 HL	L	PN 315	8	M 14 x 1.5	14,0	27,5	21	12	17
XVET NW 08 HL	L	PN 315	10	M 16 x 1.5	15,0	29,0	22	14	19
XVET NW 10 HL	L	PN 315	12	M 18 x 1.5	17,0	29,5	24	17	22
XVET NW 13 HL	L	PN 315	15	M 22 x 1.5	21,0	32,5	28	19	27
XVET NW 16 HL	L	PN 315	18	M 26 x 1.5	23,5	35,5	31	24	32
XVET NW 20 HL	L	PN 160	22	M 30 x 2	27,5	38,5	35	27	36
XVET NW 25 HL	L	PN 160	28	M 36 x 2	30,5	41,5	38	36	41
XVET NW 32 HL	L	PN 160	35	M 45 x 2	34,5	51,0	45	41	50
XVET NW 40 HL	L	PN 160	42	M 52 x 2	40,0	56,0	51	50	60
XVET NW 03 HS	S	PN 630	6	M 14 x 1.5	16,0	27,0	23	12	17
XVET NW 04 HS	S	PN 630	8	M 16 x 1.5	17,0	27,5	24	14	19
XVET NW 06 HS	S	PN 630	10	M 18 x 1.5	17,5	30,0	25	17	22
XVET NW 08 HS	S	PN 630	12	M 20 x 1.5	21,5	31,0	29	17	24
XVET NW 10 HS	S	PN 630	14	M 22 x 1.5	22,0	35,0	30	19	27
XVET NW 13 HS	S	PN 400	16	M 24 x 1.5	24,5	36,5	33	24	30
XVET NW 16 HS	S	PN 400	20	M 30 x 2	26,5	44,5	37	27	36
XVET NW 20 HS	S	PN 400	25	M 36 x 2	30,0	50,0	42	36	46
XVET NW 25 HS	S	PN 400	30	M 42 x 2	35,5	55,0	49	41	50
XVET NW 32 HS	S	PN 315	38	M 52 x 2	41,0	63,0	57	50	60

Series: LL = Very light L = Light S = Heavy – PN = Nominal pressure PB = Max. operating pressure – Ø d2 = External pipe diameter

Product versions

XVET VA	Fitting, T shaped, Stainless steel
VET	Fitting, T shaped, Steel