

GAR HF

Screw-on fitting, French series

HANSA FLEX

Properties

Connection 1	BSP cylindrical internal threads
Sealing form 1	flat sealing
Connection 2	metric cylindrical outer thread
Sealing form 2	24° inner cone
Design	Screw-on fitting
Construction type	French series
Construction	straight
Scope of supply	Socket with union nut and cutting ring
Material	Steel
Surface	electro galvanised

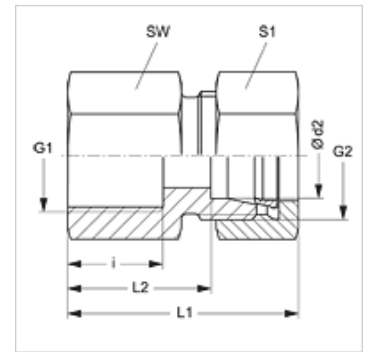

Note

Information about fitting, installation, pressure loads and permissible operating temperatures can be found in the technical information for pipe fittings.

Item

Identification	Operating pressure	Ø d2 (mm)	G1	G2	i (mm)	L1 (mm)	L2 (mm)	AF (mm)	S1
GAR NW 10 HF 1/4	PN 400	13,25	G 1/4" -19	M 20 x 1.5	12	41,5	19	22	27
GAR NW 10 HF	PN 400	13,25	G 3/8" -19	M 20 x 1.5	12	41,5	19	22	27
GAR NW 10 HF 1/2	PN 400	13,25	G 1/2" -14	M 20 x 1.5	15	45,0	22	27	30
GAR NW 13 HF 3/8	PN 250	16,75	G 3/8" -19	M 24 x 1.5	12	42,5	19	27	30
GAR NW 13 HF	PN 250	16,75	G 1/2" -14	M 24 x 1.5	14	44,5	21	27	30
GAR NW 16 HF	PN 250	21,25	G 1/2" -14	M 30 x 1.5	14	47,0	23	32	36

Series: LL = Very light L = Light S = Heavy – PN = Nominal pressure PB = Max. operating pressure – Ø d2 = External pipe diameter