

# T HF

Fitting, T shaped, French series



## Properties

<b>Connection 1 - 3</b>	metric cylindrical outer thread
<b>Sealing form 1 - 3</b>	24° inner cone
<b>Design</b>	Fitting
<b>Construction type</b>	French series
<b>Construction</b>	T shaped
<b>Scope of supply</b>	Socket with union nut and cutting ring
<b>Material</b>	Steel
<b>Surface</b>	electro galvanised

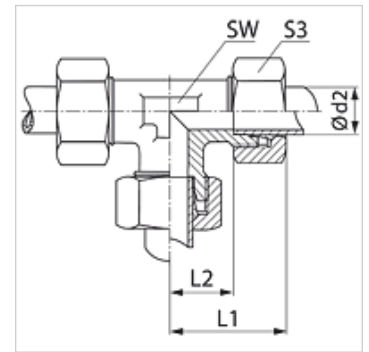

## Note

Information about fitting, installation, pressure loads and permissible operating temperatures can be found in the technical information for pipe fittings.

## Item

Identification	Operating pressure	Ø d2 (mm)	L1 (mm)	L2 (mm)	AF (mm)	S3
T NW 10 HF	PN 400	13,25	38,5	16	19	27
T NW 13 HF	PN 250	16,75	41,5	18	24	30
T NW 16 HF	PN 250	21,25	47,0	23	30	36
T NW 20 HF	PN 250	26,75	52,0	27	36	42
T NW 25 HF	PN 160	33,50	60,0	35	46	55

PN = Nominal pressure PB = Max. operating pressure – Series: LL = Very light L = Light S = Heavy – Ø d2 = External pipe diameter