

# TR HF

Screw-in fitting, T shaped, French series

**HANSA FLEX**

## Properties

|                           |  |
|---------------------------|--|
| <b>Connection 1</b>       | BSPT conical external threads          |
| <b>Sealing form 1</b>     | thread seal                            |
| <b>Connection 2 + 3</b>   | metric cylindrical outer thread        |
| <b>Sealing form 2 + 3</b> | 24° inner cone                         |
| <b>Design</b>             | Screw-in fitting                       |
| <b>Construction type</b>  | French series                          |
| <b>Construction</b>       | T shaped                               |
| <b>Scope of supply</b>    | Socket with union nut and cutting ring |
| <b>Material</b>           | Steel                                  |
| <b>Surface</b>            | electro galvanised                     |

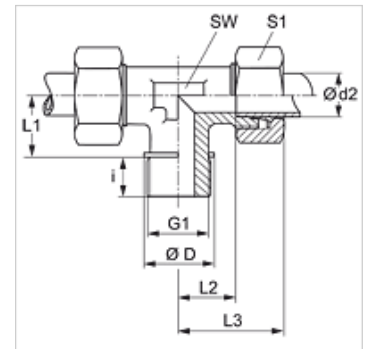

## Note

Information about fitting, installation, pressure loads and permissible operating temperatures can be found in the technical information for pipe fittings.

## Item

| Identification  | Operating pressure | Ø d2<br>(mm) | G        | i<br>(mm) | L3<br>(mm) | L4<br>(mm) | L5<br>(mm) | AF<br>(mm) | S3 |
|-----------------|--------------------|--------------|----------|-----------|------------|------------|------------|------------|----|
| TR NW 10 HF 1/4 | PN 400             | 13,25        | R 1/4" K | 12,3      | 38,5       | 16,0       | 23,5       | 19         | 27 |
| TR NW 10 HF     | PN 250             | 13,25        | R 3/8" K | 12,7      | 38,5       | 16,0       | 23,7       | 19         | 27 |
| TR NW 13 HF 3/8 | PN 250             | 16,75        | R 3/8" K | 12,7      | 41,5       | 18,0       | 25,2       | 24         | 30 |

Series: LL = Very light L = Light S = Heavy – PN = Nominal pressure PB = Max. operating pressure – Ø d2 = External pipe diameter